



# M157310AD.2

ITEM NUMBER: 157310

SERIAL NUMBER: \_\_\_\_\_

## Owner's Manual

Instructions for Set-up, Operation, Maintenance & Storage

### **HOT WATER/STEAM PRESSURE WASHER – 3000 PSI / 4 GPM** **Portable Outdoor-Use Only**

This pressure washer produces both cold and hot water high pressure spray as well as steam spray. Cleaning chemicals may be incorporated into the spray if desired. The pressure pump for this equipment is powered by a gasoline internal combustion engine and the water is heated by a kerosene/fuel-oil fired, open flame burner.



#### **WARNING – READ THIS MANUAL**

**READ and UNDERSTAND this Owner's Manual and the Engine Owner's Manual completely before attempting to set up and use the pressure washer!** Failure to properly set up, operate, and maintain this pressure washer could result in *serious injury or death* to operator or bystanders.



#### **WARNING – SPECIAL HAZARDS**

<b>CO Poisoning</b>	<ul style="list-style-type: none"> <li>Exhaust from both the engine and burner contains carbon monoxide, a poisonous gas that can cause carbon monoxide poisoning and possible death if inhaled. <b>ONLY</b> run pressure washer <b>OUTDOORS</b> and at least 20 feet from the home, away from windows, vents and air intakes, to allow proper ventilation. If you start to feel sick, dizzy, or weak while using the pressure washer, shut off the engine and get to fresh air <b>RIGHT AWAY</b>.</li> </ul>
<b>Skin/Eye Injury</b>	<ul style="list-style-type: none"> <li>High-pressure spray can cause serious skin or eye injury, including injection injury if fluid pierces the skin. Injection injury can result in blood poisoning and/or severe tissue damage.</li> </ul>
<b>Burns</b>	<ul style="list-style-type: none"> <li>Hot spray can scald and burn skin.</li> <li>Hot surfaces of wand, engine and burner, as well as hot exhaust from both the engine and burner can cause burns.</li> </ul>
<b>Slips/Falls</b>	<ul style="list-style-type: none"> <li>Spray discharge can cause puddles and slippery surfaces.</li> <li>Spray-gun kickback can cause operator loss of balance and falls.</li> </ul>
<b>Flying Debris</b>	<ul style="list-style-type: none"> <li>High-pressure spray can cause surface damage and flying debris.</li> </ul>
<b>Fire/Explosion</b>	<ul style="list-style-type: none"> <li>Engine and burner sparking can ignite fuel or other flammable liquids or vapors in the vicinity.</li> <li>Hot exhaust from engine and burner can ignite combustible materials.</li> </ul>
<b>Chemical Exposure</b>	<ul style="list-style-type: none"> <li>Cleaning chemical vapors or contact with skin may be hazardous.</li> </ul>
<b>Electric shock</b>	<ul style="list-style-type: none"> <li>Spray contact with electrical sources can cause electric shock.</li> </ul>
A summary of important safety information is provided at the end of the manual.	

**Any Questions, Comments, Problems, or Parts Orders**  
***Call NorthStar Product Support 1-800-270-0810***

# Hazard Signal Word Definitions



This is the safety alert symbol. It is used to alert you to potential personal injury hazards. Obey all safety messages that follow this symbol to avoid possible injury or death.

**DANGER** (red) indicates a hazardous situation, which if not avoided, will result in death or serious injury.

 **DANGER**

 **WARNING**

**WARNING** (orange) indicates a hazardous situation, which if not avoided, could result in death or serious injury.

 **CAUTION**

**CAUTION** (yellow), used with the safety alert symbol, indicates a hazardous situation, which if not avoided, could result in minor or moderate injury.

**CAUTION**

**CAUTION** (yellow), without the safety alert symbol, is used to address practices not related to personal injury.

**NOTICE**

**NOTICE** is used to address practices not related to personal injury.

## Equipment Protection Quick Facts

<b>Inspect Upon Delivery</b>	<b>STOP!</b> Closely inspect to make sure no components are missing or damaged. See the "Assembly and Initial Set-Up" section for instructions on whom to contact to report missing or damaged parts.	
<b>Fill with Engine Oil</b>	<b>STOP!</b> Engine is shipped <u>without</u> oil. DO NOT start pressure washer without adding oil to engine. Please refer to Engine Manual shipped with unit for acceptable grade motor oils.	
<b>Check Pump Oil</b>	Pump is shipped with oil. Remove shipping tape and black vent plug (if present) from oil fill cap.	
<b>Battery Required</b>	A battery is not included. The engine will run but the burner will not fire unless a battery is installed. Purchase a standard lawn and garden (Group U1) battery. The engine requires a 12V battery, with a minimum rating of 18 Ah (Amp-hour).	
<b>Water Flow Requirements</b>	Make sure your supply water flow rate is 20% higher than the pressure washer's flow rate (see "Specifications" section for detail), and that your water is clean and particle free.	
<b>Storage</b>	Do not allow water to freeze in the pump, hose, coil, or spray gun(s).	
<b>Chemical Spraying</b>	Use only NorthStar brand or equivalent washer chemicals designed for high-pressure use. Use soap adjustment knob to regulate cleaning power.	
<b>Maintenance Schedule</b>	Engine:	• See Engine Owner's manual.
	Pump:	• Change oil after first 40 hours, then every 3 months or 500 hours.
	Burner fuel filter /water separator:	• Drain water as needed. • Change filter after every 500 hours of use.
	Coil:	• Descale coil annually or more frequently as conditions/performance require. • Inspect coil for soot build-up annually and clean if needed.
	Electrodes:	• Inspect electrodes annually and clean/adjust as needed.

# Table of Contents

<b>About Your Pressure Washer .....</b>	<b>4</b>
<b>Specifications .....</b>	<b>5</b>
<b>Component Identification.....</b>	<b>6</b>
<b>Safety Labeling.....</b>	<b>7</b>
<b>Special Equipment Safety Features .....</b>	<b>8</b>
<b>Assembly and Initial Set-Up.....</b>	<b>9</b>
Step 1. Unpacking & Delivery Inspection .....	9
Step 2. Assembly.....	11
Step 3. Initial Pump & Engine Preparation.....	12
Step 4. Battery Installation.....	13
<b>Moving and Handling .....</b>	<b>14</b>
<b>Before Each Use.....</b>	<b>15</b>
Step 1. Check Equipment.....	15
Step 2. Add Fuel(s) .....	16
Step 3. Select a Suitable Worksite .....	18
<b>Operation .....</b>	<b>20</b>
Step 1. Connect Hose(s), Water Supply, and Spray Nozzle(s) .....	20
Step 2. Set Up for Chemical Spray (if desired).....	23
Step 3. Spraying .....	25
Step 4. Stopping .....	31
<b>Storage.....</b>	<b>31</b>
<b>Burner Adjustment .....</b>	<b>34</b>
<b>Maintenance and Repair .....</b>	<b>36</b>
<b>Troubleshooting .....</b>	<b>45</b>
<b>Parts Explosion.....</b>	<b>46</b>
<b>Wiring Diagrams.....</b>	<b>49</b>
<b>Summary of Important Safety Information .....</b>	<b>50</b>
<b>Limited Warranty .....</b>	<b>54</b>

## About Your Pressure Washer

Thank you for purchasing a NorthStar hot water pressure washer! Your machine is designed for long life, dependability, and the top performance you demand. This pressure washer is designed to:

- 1) Produce a high-pressure steam spray or water spray (heated or unheated) – up to 4 gallons per minute at 3000 psi.
- 2) Incorporate cleaning chemicals into a low-pressure water spray.

The pump requires a clean, standard tap water supply provided through a garden hose at a flow rate of at least 4.8 gallons per minute. The use of a backflow preventer on the water supply hose is recommended and may be required by local code. Any cleaning chemicals that are used must be specifically approved for use in pressure washers.

The pump is powered by a gasoline-fueled engine. The spray water is heated (when desired) by a kerosene/fuel-oil fired, spark-ignited, open flame burner. Normal operation of this equipment will require you to supply:

- Gasoline fuel and lubrication oil for the engine
- Fuel for the burner (kerosene, diesel, or fuel oil)
- A 12-volt standard lawn and garden battery

See the "**Specifications**" section of this manual for more detail.

**Gasoline powered pressure washers are for OUTDOOR USE ONLY.** Be sure to read about site selection for running this pressure washer in the "**Installation & Initial Set-up**" section of this manual.

The user should plan to acquire and wear safety apparel during operation of this pressure washer. Safety apparel includes waterproof insulated gloves, safety glasses with side and top protection, and non-slip protective footwear. Some cleaning chemicals may require the use of a respirator mask (as instructed on chemical label).

Before using this washer, the user shall determine the suitability of this product for its intended use and assumes liability therein.

### **Read this Manual**

#### **WARNING**

**Carefully read and follow all instructions and safety information** for using this pressure washer. Improper use or maintenance of the pressure washer can result in *serious injury or death* to the operator or bystanders from:

- |                                                   |                         |                                |
|---------------------------------------------------|-------------------------|--------------------------------|
| • <i>Carbon monoxide poisoning</i>                | • <i>Fire/explosion</i> | • <i>Chemical exposure</i>     |
| • <i>Skin/eye injury from high pressure spray</i> | • <i>Burns</i>          | • <i>Slips/falls</i>           |
|                                                   | • <i>Electric shock</i> | • <i>Flying objects/debris</i> |

Keep this manual for reference and review. A summary of important safety information can be found at the end of the manual.

Proper preparation, operation, and maintenance of this pressure washer will result in optimal performance and a long life for this equipment. For detailed Engine operation and maintenance information, always refer to the Engine Owner's Manual furnished with the pressure washer.

#### **ATTENTION:**

##### **Rental Companies and Private Owners who loan this equipment to others!**

All persons to whom you rent/loan this pressure washer must have access to and read this manual. Keep this owner's manual with the pressure washer at all times and advise all persons who will operate the machine to read it. You must also provide personal instruction on how to safely set-up and operate the pressure washer and remain available to answer any questions a renter/borrower might have.

## Specifications

<b>MODEL</b>	
Model #	157310
<b>FLOW OUTPUT</b>	
Pressure Rating	3000 psi
Flow Rate	4 gpm
Maximum Temperature	250° F
<b>DIMENSIONS / COMPONENTS</b>	
Length	64"
Width	33"
Height	44"
Weight	557 lbs. – dry 710 lbs. – fueled
Pump Type	CAT 66DX
Engine Horsepower	390cc
Engine and Burner Fuel Tank Sizes	8.75 gallon
High Pressure Discharge Hose	3/8" x 50'
Chemical Injector	Maximum dilution ratio 13-to-1
<b>SUPPLIES REQUIRED (not included)</b>	
Engine Fuel	Regular, Unleaded Gasoline
Engine Oil	See Engine Owner's Manual
Burner Fuel	#1 or #2 Diesel, B5 or lower Biodiesel, Kerosene, or Fuel Oil
Pump Oil (shipped with oil, but refills required)	SAE 30 non-detergent oil
Battery	12 Volt, minimum 18 Amp/Hr. Lawn and Garden Battery (Group U1)
Input Water Supply	Standard tap water @ 20-75 psi, delivered @ 4.8 gpm
Input Water Supply Hose	Standard garden hose with inside diameter at least 5/8" (at least 3/4" diameter if hose longer than 100 ft.)

## Component Identification

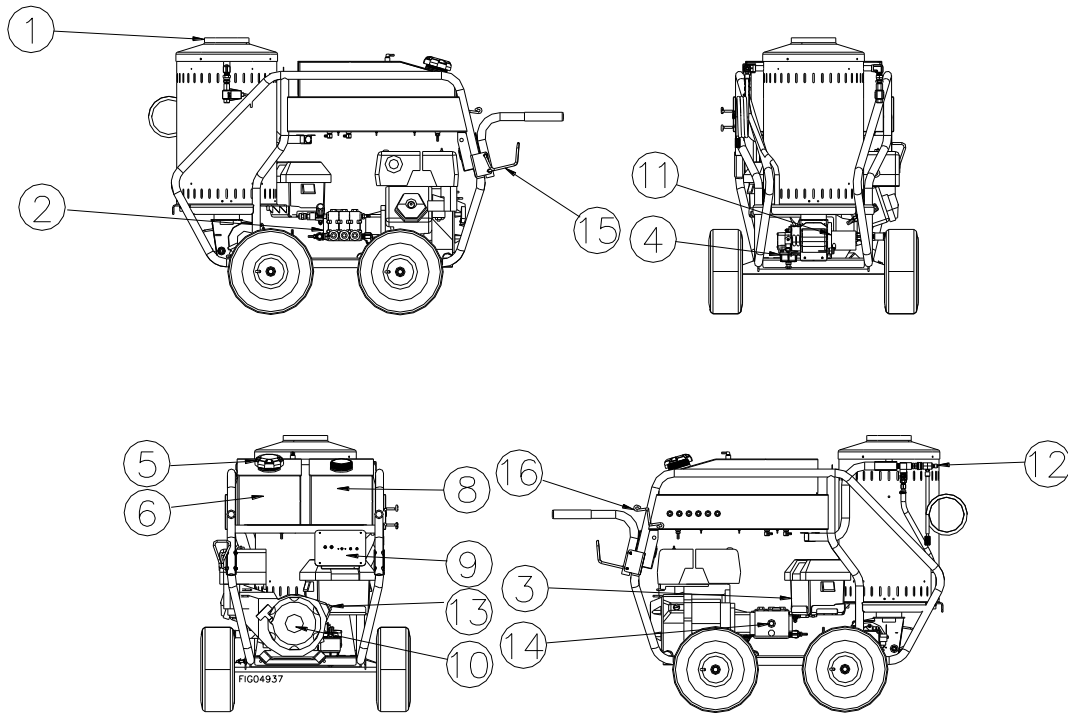

Ref #	Description	Ref #	Description
1	Exhaust Vent	9	Control Panel
2	Pump	10	Engine
3	Battery Box	11	Burner
4	Fuel Filter/Water Separator	12	High Pressure Water Outlet
5	Gas Cap	13	Engine on/off key switch
6	Gas Tank	14	Pump Oil Sight Glass
7	Fuel Cap	15	Hose Hook
8	Fuel Tank	16	Gun Hook

REFERENCE GUIDE	
<b>1. Exhaust Vent</b>	Provides an out for burner exhaust gases.
<b>2. Pump</b>	A device that moves fluid through a combination of suction and displacement.
<b>3. Battery Box</b>	Storage place to house the battery.
<b>4. Fuel Filter / Water Separator</b>	Filter in fuel line that removes water and screens out dirt and debris from fuel.
<b>5. Gas Cap</b>	Cover for gas tank.
<b>6. Gas Tank</b>	Gas storage container.
<b>7. Fuel Cap</b>	Cover for fuel tank.
<b>8. Fuel Tank</b>	Fuel storage container.
<b>9. Control Panel</b>	Flat surface for mounting switches.
<b>10. Engine</b>	The air-cooled engine powers the pump.
<b>11. Burner</b>	A device used to efficiently convert fuel oil or gas into heat energy.
<b>12. High Pressure Outlet</b>	A passage for water to exit pump/heat exchanger and enter the hose.
<b>13. Engine on /off key switch</b>	The engine key is located on the engine. Always locate this switch and be familiar with its location before operating the pressure washer.

# Safety Labeling

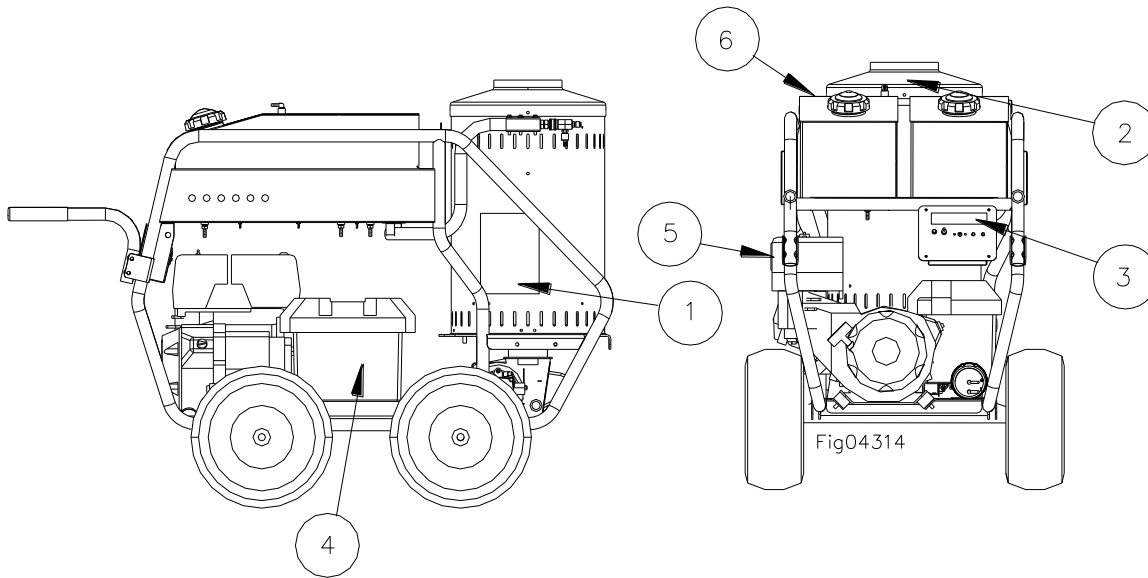

1.) **DANGER**

FOR OUTDOOR USE ONLY! Using this pressure washer indoors CAN KILL YOU IN MINUTES. Engine exhaust and burner exhaust contain carbon monoxide. This is a poison you cannot see or smell.

NEVER use inside any building, structure or garage, EVEN IF doors and windows are open.

Only use OUTSIDE and far away from windows, doors, and vents.

**WARNING**

**High Pressure Fluid Forces / Burn Hazards**  
High pressure spray can cause injection injury, eye injury, and loss of balance. Hot discharge fluid and hot surfaces can burn.

- NEVER direct discharge stream at or near any person. Do not allow any part of the body to come in contact with the fluid stream.
- Gun kicks back - hold with two hands. Keep good footing and balance at all times.
- Surfaces of engine, burner, and wand can become very hot. Use only designated gripping area of wand. Avoid contact with hot engine and burner.

**Fire / Explosion Hazard**  
Spraying flammables can cause explosion. Fuel is flammable and explosive. Exhaust can ignite combustible materials.

- NEVER spray flammable liquids. Operate only where open flame or torch is permitted.
- NEVER fuel a running or hot engine or oil burner.
- Ensure there are no fuel leaks before starting. Keep sources of sparks and flames away.
- Use approved container only for transferring fuel. Clean up fuel spills immediately.
- Keep engine and burner exhaust at least 7 feet from all combustible objects. Situate on heat-resistant flooring when using burner.

**Chemical Exposure Hazard**

- Understand all safety hazards and first aid measures for chemicals being used.
- Follow chemical manufacturer's directions when handling and cleaning with chemicals. Wear safety gear as directed.

**Electric Shock Hazard**

- Keep spray away from electrical wiring, or electric shock / electrocution could occur.

CAUTION: To Reduce Risk of Injury, Read Operating Instructions Carefully Before Using.

5.) **WARNING**

**BURN HAZARD**  
Do not touch hot muffler.

3.) **IMPORTANT!**

TURN HEAT SWITCH TO OFF POSITION WHEN NOT IN USE.

4.) **WARNING - BATTERY HAZARDS**

**BATTERIES:**

1) contain caustic acid, 2) emit explosive gases, 3) can cause electric shock

- ALWAYS use eye protection. Caustic acid and explosive gases can cause blindness or severe burns.
- NO smoking, sparks, or flames.
- NEVER touch both battery terminals at the same time with your hand or any non-insulated tools.
- FLUSH immediately with water if battery acid contacts eyes, skin, or clothing.
- CONNECT cables in correct sequence: FIRST RED to POSITIVE terminal, then BLACK to NEGATIVE terminal. When disconnecting, DISCONNECT BLACK cable first, then RED.
- NEVER charge a visibly damaged or frozen battery. ALWAYS read and follow charger instructions.

6.) **WARNING**

**Fire & Overheating Hazard**  
DO NOT overfill fuel tank.

Fill fuel only to bottom of fill neck. Expansion of fuel from heat of sun or normal operation may cause tank spillage if overfilled. Wipe up fuel spills and allow to dry before starting engine.

2.) **CAUTION HOT!**

Always make sure safety labels are in place and in good condition. If a safety label is missing or not legible, order new labels or unsafe operation could result. To order replacement safety labels, call Northstar Product Support at 1-800-270-0810.

Ref#	On-Product Warning Labels	
	Part #'s	Description
1	782325	Danger & Warning
2	305410	Caution Hot
3	778464	Control panel
4	782397	Battery Hazard
5	786635	Burn Hazard
6	786837	Fuel Fill Warning

## Special Equipment Safety Features

### High Pressure Safety Device (Rupture Disc)

**⚠ WARNING-If the high-pressure safety device ever discharges water, turn the engine off and do not use the machine. The device will no longer function properly. See a dealer or call Product Support at 1-800-270-0810.**

This unit is equipped with a high pressure safety device, which acts as a backup safety feature. If the unloader malfunctions, the high pressure safety device will open and relieve excess system pressure.

High Pressure Safety Device

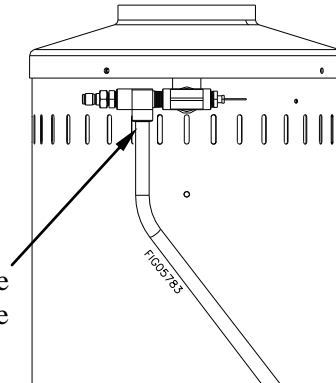

### High Temperature Limit / Thermostat

This unit is equipped with a high temperature limit that measures discharge spray temperature and automatically turns the burner off when the temperature setting is reached. When the discharge spray temperature drops, the burner automatically reignites.

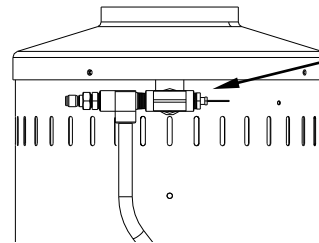

High temp limit

Note: Shield not shown for clarity

### Thermal Relief Valve

This unit is equipped with a thermal relief valve to protect the pump from overheating. The pump continues to work in bypass mode when you are not spraying. If high temperatures are developed during bypass mode, the thermal relief valve will open and discharge hot water onto the ground, protecting the pump from overheating. The thermal relief valve is located on the inlet filter.

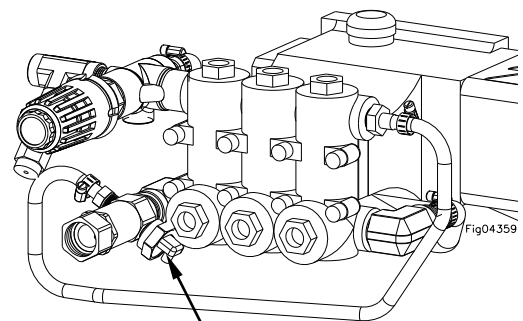

Thermal relief valve

### Spray Gun Safety Latch

The spray gun is equipped with a built-in trigger safety latch to guard against accidental trigger actuation.

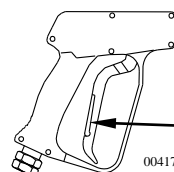

Safety Latch



# Assembly and Initial Set-Up

## Steps for Assembly / Initial Set-Up

- Step 1. Unpacking & Delivery Inspection**
- Step 2. Assembly**
- Step 3. Initial Pump & Engine Preparation**
- Step 4. Battery Installation**

Each of these steps is discussed in the below:

### **Step 1. Unpacking & Delivery Inspection**

Find and separate the components identified in Figure 2- Overview of Pressure Washer Components and Figure 3- Hardware Bag. Inspect the pressure washer immediately after you receive delivery for missing parts and damage.

- If you have missing or damaged components, contact Product Support at 1-800-270-0810.

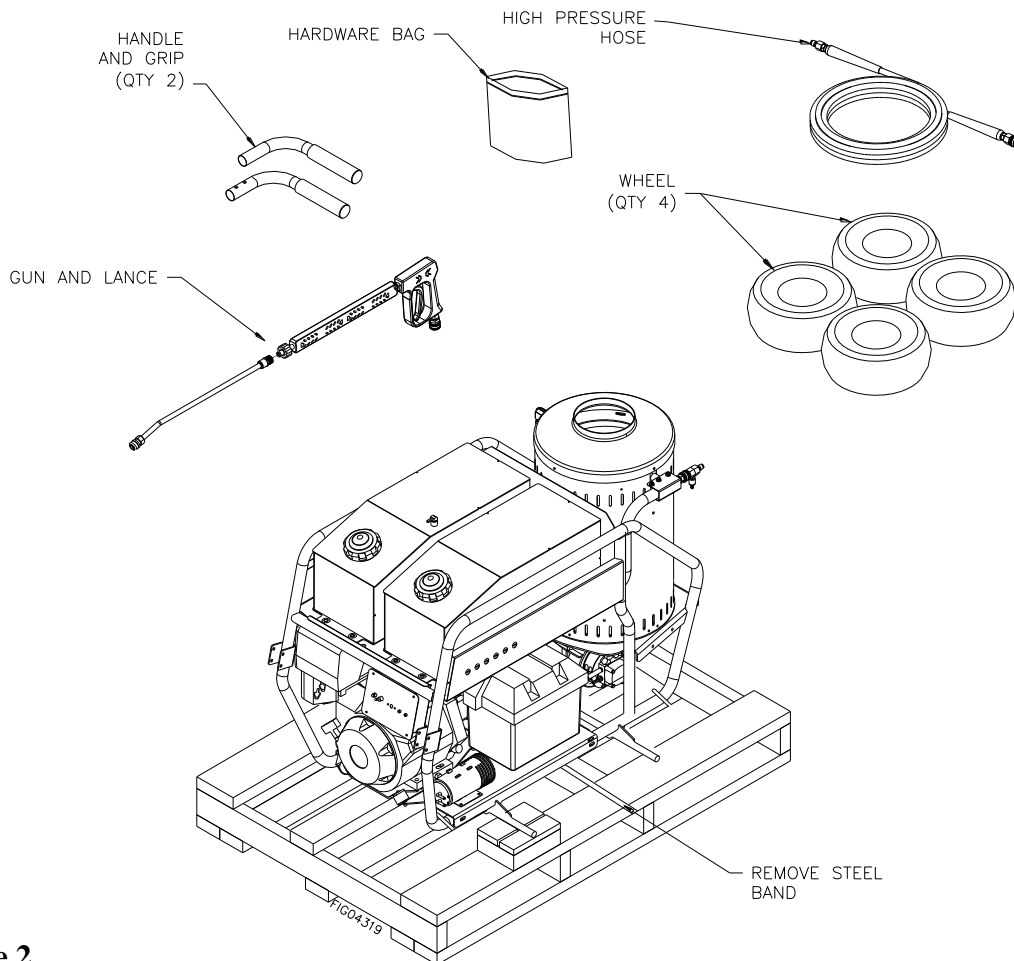

**Figure 2**

# Assembly and Initial Set-Up

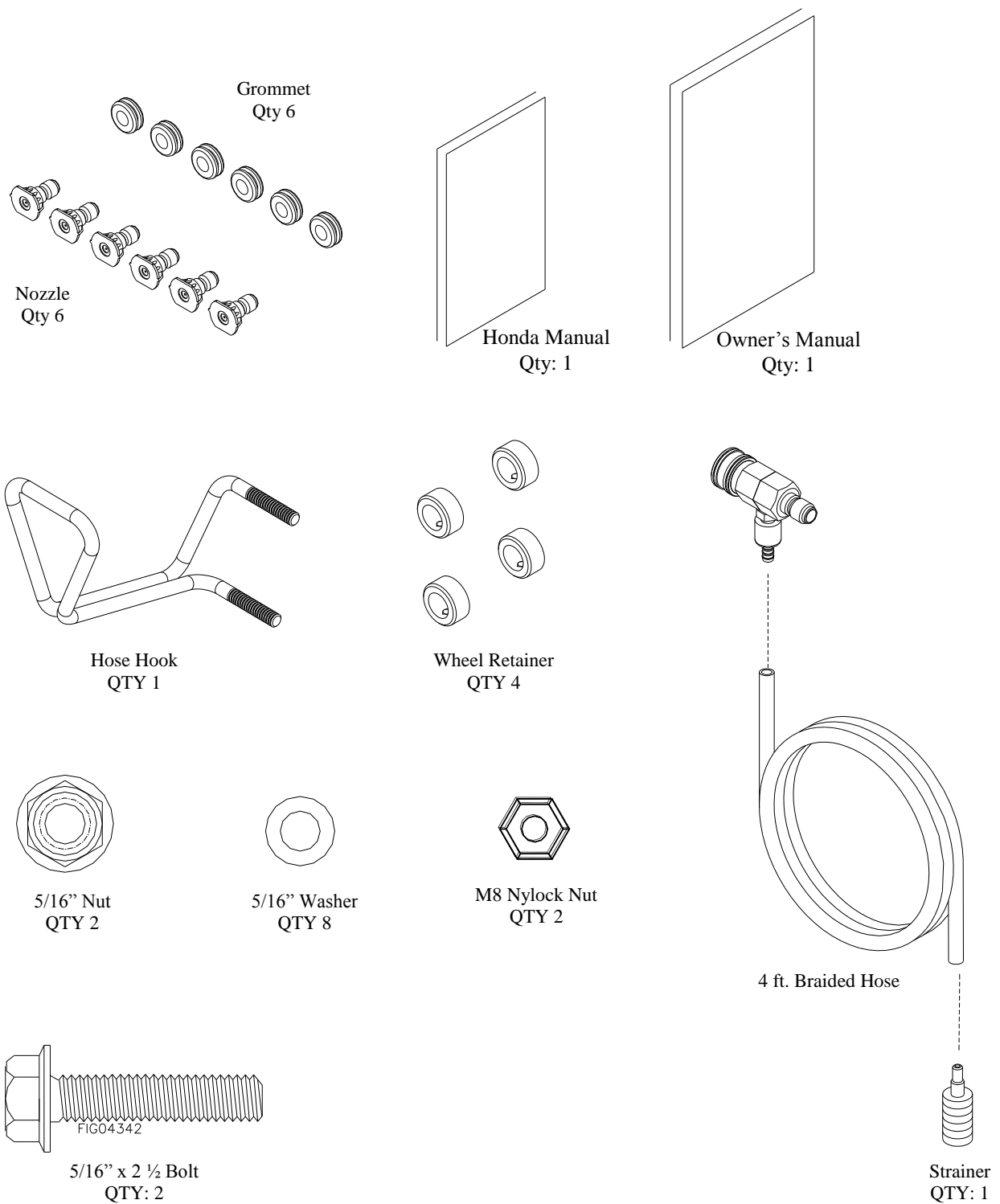
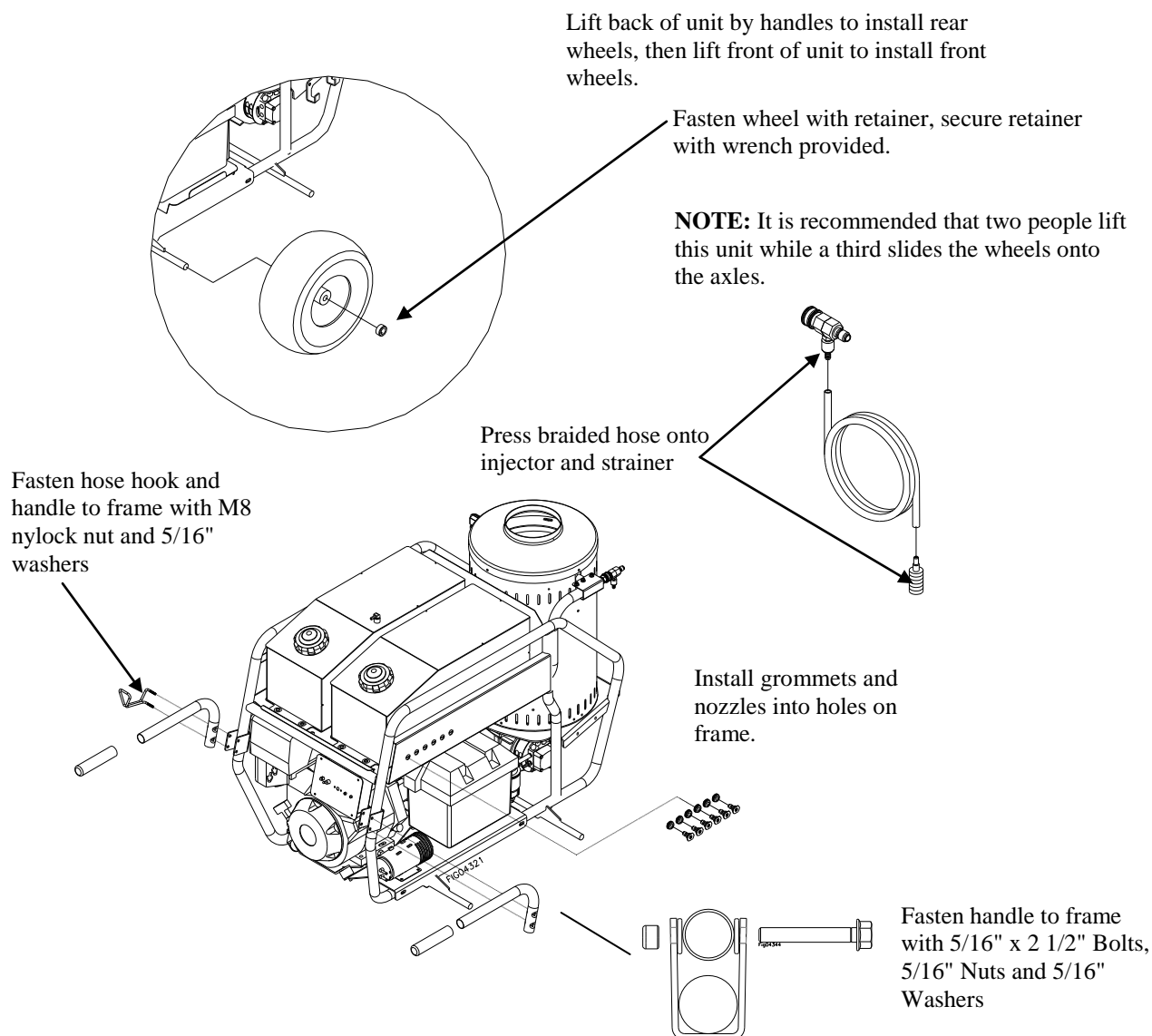

**Figure 3**

# Assembly and Initial Set-Up

## Step 2. Assembly

You must assemble your pressure washer before it can be used. See below:



**Step 1.** Fasten handles to frame with 5/16" x 2 1/2" bolts, 5/16" nuts and 2x 5/16" washers.

**Step 2.** Press chemical injector onto one end of the braided hose. Press strainer onto other end of the braided hose.

**Step 3.** Install grommets and nozzles into holes in frame.

**Step 4.** Install wheels:

**⚠ WARNING:** The pressure washer is heavy. It can crush and cause serious injury if it rolls out of control or tips over. Always use at least two people or a mechanical assist to lift the unit while a third person slides the wheels onto the axles.

## Assembly and Initial Set-Up

a. **Rear Wheels**

Have two people lift the back of the pressure washer by the handles while a third person slides the wheels onto the Rear Axle. Fasten each wheel with a wheel retainer using a hex wrench.

b. **Front Wheels**

Have two people lift the front of the pressure washer while a third person slides the wheels onto the Front Axle. Fasten each wheel with a wheel retainer using a hex wrench.

**Step 5.** Use a mechanical assist or two people to lift the assembled pressure washer off of the pallet.

### Step 3. Initial Pump & Engine Preparation

**Prepare Water Pump**

**Verify pump oil level.**

Note: The pump is shipped with oil.

1. Verify oil level:
  - a. Remove shipping tape and black vent plug (if present) from oil fill cap.
  - b. Verify that oil level is half way up the sight glass.
1. If oil level is low, fill using SAE30 non-detergent oil or Cat Pump Oil Item #22158.
2. Replace oil fill cap.

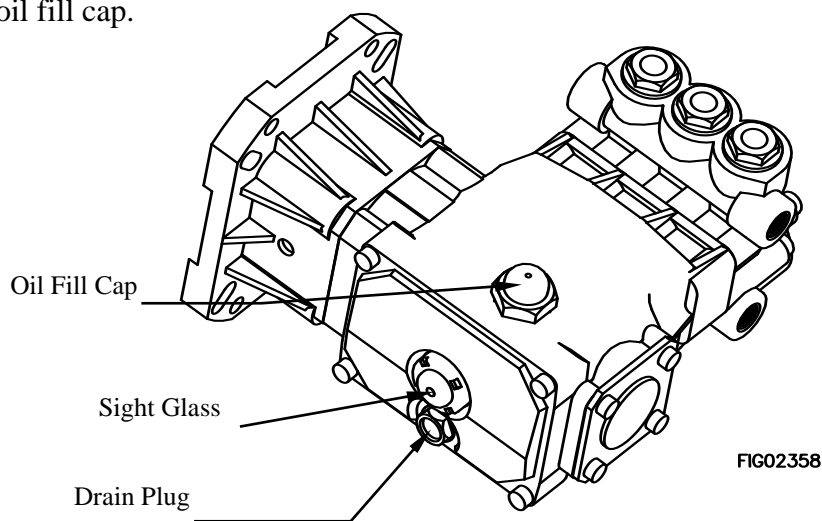

FIG02358

**Figure 5**

**Prepare Engine**

**Fill the engine with oil.**

Note: The engine is shipped without oil.

Refer to the Engine Manual to locate oil-fill port and for instructions on filling. Use the oil grade and quantity specified in the Engine Manual.

# Assembly and Initial Set-Up

## Step 4. Battery Installation

**Install a 12-volt standard lawn and garden battery (Group U1) with a minimum 18 amp-hour rating.** The engine will run, but the burner will not fire unless a battery is installed.

The battery is to be supplied by the customer and should be installed in the protective battery compartment located near the engine.

Follow the steps below for connecting and disconnecting the battery.

### **WARNING: Battery Hazards**

Batteries are hazardous because they contain caustic acid, can emit explosive gases, and can cause electric shock. Caution must be exercised when making connections to a battery to avoid shock and contact with the acid, and to prevent any sparking that could lead to an explosion. ALWAYS follow the general battery safety rules and instructions listed below.

#### **General Battery Safety Rules**

- ALWAYS use eye protection and protective clothing when handling batteries.
- NEVER smoke or work near sparks or other sources of ignition.
- NEVER touch both battery terminals at the same time with your hand or any non-insulated tools.
- If battery acid contacts skin or clothing, flush immediately with water and neutralize with baking soda.

#### **Connecting the battery**

Always connect the cables in the following sequence to avoid possible shock:

1. Find the battery cables located inside the battery compartment.
2. Connect the **red** cable to the **positive (+)** terminal of the battery.
3. Then connect the **black** cable to the **negative (-)** terminal of the battery.

#### **Disconnecting the battery**

Always disconnect cables in the following sequence to avoid possible shock.

1. First, disconnect the **black** cable from the **negative (-)** terminal of the battery.
2. Next, disconnect the **red** cable from the **positive (+)** terminal of the battery.
3. Remove the battery from the battery compartment.

## Moving and Handling

### **⚠WARNING**

The pressure washer is heavy. It can crush and cause serious injury if it rolls out of control or tips over. Follow the instructions below for safely moving the pressure washer.

### Moving and Handling

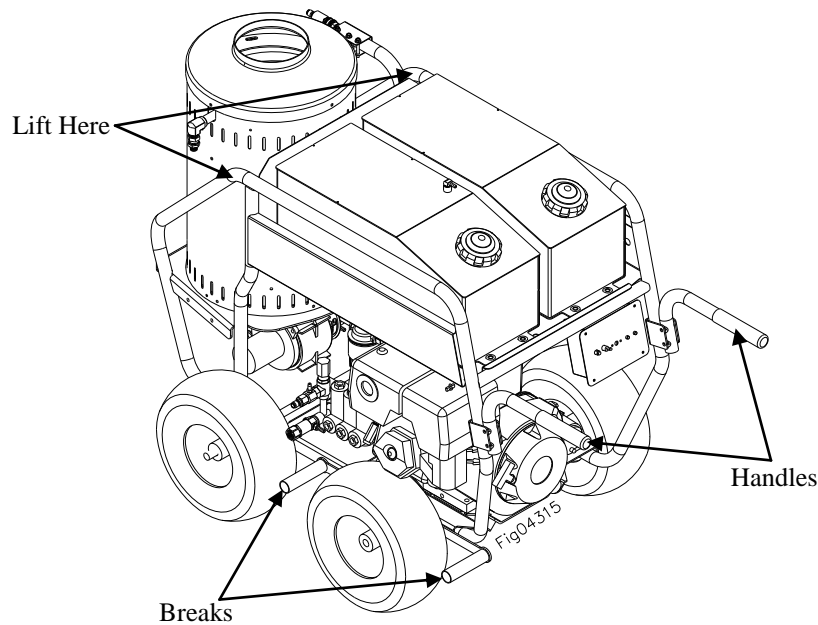

**Figure 7**

#### **Moving your pressure washer around**

1. Use the handle to manually move the pressure washer.
2. To turn, lift slightly on the handle and pivot the pressure washer on its front wheels.
3. Engage brakes to prevent inadvertent movement. Pull brake arms out, rotate them down, and use them as chocks. (See Figure 7)

#### **Elevating or lowering your pressure washer**

To reduce risk of injury, use a hoist or shallow ramp to raise or lower the pressure washer. When using a hoist, lift from the lifting points. (See Figure 7).

## Before Each Use

Follow the steps below prior to each use of the pressure washer.

### Steps to Follow Before Each Use

**Step 1. Check Equipment**

**Step 2. Add Fuel(s)**

**Step 3. Select Suitable Worksite**

### Step 1. Check Equipment

#### Check/add pump oil

#### Check/add pump oil.

Caution: Never run the pump without sufficient lubrication!

1. Check oil level. Verify that oil level is half way up the sight glass.
2. If oil level is low, fill using SAE30 non-detergent oil or Cat Pump Oil Item #22158.
3. Replace fill cap.

#### Check/add engine oil

#### Check the engine oil level and add oil as needed.

Use the recommended oil type for your engine and expected ambient conditions. (See engine Owner's Manual for oil type and capacity, and more detailed oil check/fill instructions.)



#### **WARNING: Burn hazard**

Never open oil port while engine is running. Hot oil can spray over face and body.

#### Notes:

- Low oil shutdown feature prevents the engine from starting without sufficient oil.
- Engine is shipped without oil. You must add oil before first use.

#### Inspect spray system

#### Always inspect spray system for damage and leaks before each use.

Do not start pressure washer until all needed repairs have been completed.



#### **WARNING: High pressure fluid injection hazard**

High-pressure fluid discharge from leaks (even pin-sized) or ruptured components can pierce skin and inject fluid into the body. Injection injury can result in blood poisoning and/or severe tissue damage leading to infection, gangrene, and possibly amputation.

- Never use a finger or skin to check for leaks.
- Never operate machine with damaged or missing hoses/parts.
- Never attempt to repair a high-pressure hose or component – Always replace it with a part that is rated at or above the pressure rating of this machine.

## Before Each Use

	<ol style="list-style-type: none"> <li>1) Check hoses, fittings, wand, trigger gun and connections for signs of wear, cracks, looseness, or leaks. Replace as required.</li> <li>2) Check and clean the nozzle orifice.</li> <li>3) Clean inlet filter. (See Maintenance instructions)</li> </ol>
<b>Inspect fuel system</b>	<p><b>Always inspect (engine and burner) fuel systems &amp; check for leaks BEFORE starting pressure washer.</b></p> <p>Do not start pressure washer until all needed repairs have been completed.</p> <p><b>⚠ WARNING:</b> Fuel leak hazard Gasoline and burner fuels are highly explosive and fuel leaks can result in fire or explosions. You can be burned and seriously injured if the fuel system is not properly hooked up or there is a fuel leak when you start the engine.</p> <p>Inspect the entire fuel system. Look for:</p> <ul style="list-style-type: none"> <li>• signs of leaks or deterioration,</li> <li>• chafed or spongy fuel hose,</li> <li>• loose connections,</li> <li>• loose or missing fuel hose clamps,</li> <li>• damaged gasoline tank, or</li> <li>• defective gasoline shut-off valve.</li> </ul>
<b>Perform other scheduled maintenance as needed</b>	<p><b>Make sure that any other regular maintenance has been performed as prescribed in this manual in the "Maintenance &amp; Repair" section.</b></p> <ol style="list-style-type: none"> <li>1. Refer to the engine owner's manual for engine maintenance instructions.</li> <li>2. Make sure battery is charged. Charge as needed according to your battery manufacturer's instructions.</li> </ol>

## Step 2. Add Fuel(s)

### **⚠ WARNING: Fuel fire/explosion hazard**

Gasoline is highly flammable and explosive. Burner fuels are combustible at warm temperatures. Heat, sparks, and flames can ignite fuel vapors, which can become widespread during fueling. A flash fire and/or explosion could result and cause serious injury or death. Always use extreme care when handling fuels. Carefully follow all instructions to avoid the following conditions which could result in fuel ignition:

- gas vapor collection inside enclosures
- static electric sparks
- sparks from electric wiring, batteries, or running engines
- sources of heat (such as a hot engine, burner or exhaust)
- open flames, including pilot lights



### **Always follow these general safety rules when fueling:**

- 1) Turn pressure washer off and allow to cool for at least two minutes before removing any fuel cap.



## Before Each Use

Note: A running or still-hot engine or burner is hot enough to ignite fuel.

- 2) Fill fuel tank OUTDOORS – never indoors. Fuel vapors can ignite if they collect inside an enclosure and explosion can result.
- 3) Stay away from all sources of heat, sparks, and flames. Do not smoke.
- 4) Never pump fuel directly into the gas tank or burner at a gas station – it could cause a static electric spark. Follow these steps to avoid static electric sparking during fueling:
  - Use an approved portable container to transfer fuel to the pressure washer's tank. (A portable container made of metal or conductive plastic is preferred because it dissipates charge to ground more readily.)
  - Always place container on the ground to be filled. Never fill the portable gas container while it is sitting inside a vehicle, trailer, trunk, or pick-up truck bed.
  - Dissipate static charge from your body before beginning the fueling process by touching a grounded metal object at a safe distance from fuel sources.
  - Keep nozzle in contact with container while filling. Do not use a nozzle lock-open device.
- 5) Clean up fuel spills /splashes immediately.
  - If possible, move the pressure washer away from spilled fuel on the ground.
  - Wipe up spilled fuel and wait 5 minutes for excess fuel to evaporate before starting engine.
  - Fuel soaked rags are flammable and should be disposed of properly.
  - If fuel is spilled on your skin or clothes, change clothes and wash skin immediately.

### Fill engine fuel tank

**Check the gasoline tank level. If needed, fill tank** with fresh unleaded gasoline from a portable container:

- 1) Remove engine gas cap.
- 2) Add gasoline through the fill opening:
  - Use only a UL-approved portable gasoline container to transfer the gasoline to engine's tank.
  - Do NOT overfill the gasoline tank. Allow at least 1/2" of empty space below the fill neck to allow for fuel expansion.
- 3) Replace gas cap securely before starting engine.
- 4) Store extra gasoline in a cool, dry place in an UL-approved, tightly sealed container.

### Fill burner fuel tank (if planning to use heated water)

**If you are planning to use heated water, fill burner fuel tank with #1 or #2 diesel, B5 or lower biodiesel, kerosene, or fuel oil.**

- 1) Remove burner fuel cap.
- 2) Add fuel through the fill opening. Do not overfill. Allow at least 1/2" of empty space below fill neck to allow for fuel expansion.
- 3) Replace fuel cap securely before starting engine.
- 4) Wipe any excess fuel from unit before starting

## Before Each Use

### Step 3. Select Suitable Outdoor Worksite

Before using the pressure washer, you must understand the criteria for selecting a suitable location for operation. Note that this pressure washer is for OUTDOOR USE only.

#### **WARNING:**

You must choose a suitable site for operating your pressure washer to avoid equipment damage and/or injury and possible death from carbon monoxide poisoning, fire/explosion, uncontrolled equipment movement/tip over, or slips and falls. Choose a site that meets all of the following five criteria:

1. OUTDOORS only, and away from all building windows and air intakes.
2. Where no flammable vapors, dusts, and gases are present.
3. Where there is adequate, unobstructed ventilation airflow.
4. With adequate clearance from combustible materials.
5. On a firm, level, heat-resistant surface with good drainage.

Detail regarding each of these criteria are provided below.

#### **1. Outdoors ONLY**



#### **DANGER: Carbon monoxide poisoning hazard**

Exhaust fumes from both the engine and the burner contain carbon monoxide (CO), a poisonous gas you cannot see, smell, or taste. The CO generated by the pressure washer can rapidly accumulate, even in areas that appear to be well ventilated, resulting in dangerous and fatal concentrations within minutes. Follow the directions below for choosing a location to operate your pressure washer in order to avoid carbon monoxide poisoning.

**The location you choose to operate the pressure washer must be OUTDOORS and at least 20 feet from the home, away from windows, vents and air intakes, to allow proper ventilation. If you start to feel sick, dizzy, or weak while using the pressure washer, shut off the engine and get to fresh air RIGHT AWAY.**

- Never run the pressure washer in an enclosed or partially enclosed location such as a building, garage, barn, shed, or house. *These spaces can trap poisonous gases. Running a fan or opening windows will not provide adequate ventilation to prevent dangerous CO build-up.*
- Only use the pressure washer outdoors and far away from open windows, doors, and building or vehicle vents.
- Place the pressure washer so that the exhaust fumes will not be directed towards people or building air intakes.
- Ensure that working, battery-operated or battery back-up carbon monoxide alarms are used in any dwelling/structure that is in close proximity to the running pressure washer.
- Note that this pressure washer is NOT designed or approved for use in vehicles or marine applications. Never run the pressure washer inside RVs or other vehicles, on boats, or on pick-up truck beds.

## Before Each Use

	<p><b>⚠ WARNING:</b>            Never attempt to attach ductwork to the engine muffler or burner exhaust to allow for installation inside an enclosure. This could cause hot air deflection, heat build-up, and increased exhaust backpressure, resulting in possible exhaust leakage or overheating and damage to the pressure washer.</p>
<b>2. Away from combustible dust, liquids, or vapors</b>	<p><b>Do not locate and use the pressure washer in the presence of flammable vapors, dust, gases, or other potentially combustible materials.</b> Burner is an open flame, which can ignite airborne dusts and flammable vapors. Operate only where open flame or torch is permitted.</p>
<b>3. Adequate ventilation airflow</b>	<p><b>The pressure washer needs adequate, unobstructed flow of air to allow for proper combustion and adequate cooling.</b> Proper combustion can only be obtained when there is a sufficient supply of oxygen available for the amount of fuel being burned. Cooling ventilation is required to prevent overheating of the pressure washer and possible fire.</p> <ul style="list-style-type: none"> <li>• Situate so there is adequate clearance around pressure washer to allow for airflow – at least 7 feet from any non-combustible wall or obstruction.</li> <li>• Never place any objects against or on top of the pressure washer.</li> <li>• Do not operate with a tarp, blanket, or cover surrounding the pressure washer.</li> </ul>
<b>4. Hot exhaust clearance</b>	<p><b>The exhaust gas from your pressure washer is extremely hot and can cause combustible materials to catch on fire.</b></p> <ul style="list-style-type: none"> <li>• Make sure both the engine exhaust and burner exhaust are at least 7 feet from all combustible materials and structures during operation.</li> <li>• Equip the engine with a spark arrestor if the pressure washer will be used near any ignitable forest, brush, or grassy land. (See the engine manual provided with this equipment to determine if the engine is already equipped.) Make sure you comply with applicable local, state, and federal codes.</li> <li>• Keep a fire extinguisher rated "ABC" nearby. Keep it properly charged and be familiar with its use.</li> </ul>
<b>5. Firm, level, heat-resistant surface with nearby water supply</b>	<p><b>The pressure washer should be positioned on a firm, level (less than 3 degree slope), heat-resistant surface with good drainage and a nearby water supply.</b> The pressure washer should be placed within garden hose distance of a continuous water supply. Ensure that the pressure washer sits level and will not slide or shift during operation. If applicable, block the pressure washer's wheels to prevent movement. Surface should be heat resistant if you will be using the burner for heated spray.</p>

# Operation

After you have checked and fueled the equipment and positioned it in a suitable worksite, it is time to start your pressure washer. The following are the procedures necessary for safe, successful operation of your pressure washer.

## **WARNING**

**Carefully read and make sure you understand all instructions and safety information** before using the pressure washer. Improper use of the pressure washer can result in *serious injury or death* to the operator or bystanders from:

- *Carbon monoxide poisoning*
- *Fire/explosion*
- *Chemical exposure*
- *Skin/eye injury from high pressure spray*
- *Burns*
- *Slips/falls*
- *Electric shock*
- *Flying objects/debris*

## **Operating Instructions**

**Step 1. Connect Hoses, Water Supply, and Spray Nozzle**

**Step 2. Set Up for Chemical Spray** (if desired)

**Step 3. Spraying**

**Step 4. Stopping**

Each of these procedures is discussed in detail below:

## **Step 1. Connect Hoses, Water Supply, and Spray Nozzle**

### **Position pressure washer for use**

**Place pressure washer in a suitable location for use**, as directed in the "Before Each Use, Step 3: Select Suitable Worksite" section of this manual. A suitable location is:

- OUTDOORS only, away from all building air intakes.
- Where no flammable vapors, dusts, and gases are present.
- Where there is adequate, unobstructed ventilation airflow.
- With adequate clearance from combustible materials.
- On a firm, level, heat-resistant surface with good drainage and nearby access to a continuous water supply.

### **DANGER: Carbon monoxide poisoning hazard**

Exhaust fumes from both the engine and the burner contain carbon monoxide (CO), a poisonous gas you cannot see, smell, or taste. The CO generated by the pressure washer can rapidly accumulate, even in areas that appear to be well ventilated, resulting in dangerous and fatal concentrations within minutes. **ONLY** run pressure washer OUTDOORS and at least 20 feet from the home, away from windows, vents and air intakes, to allow proper ventilation. If you start to feel sick, dizzy, or weak while using the pressure washer, shut off the engine and get to fresh air **RIGHT AWAY**. **NEVER** run pressure washer inside any enclosed or semi-enclosed spaces,

# Operation

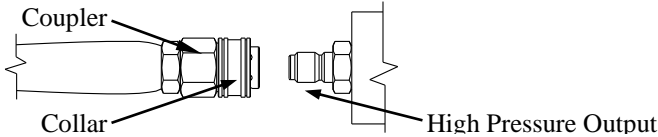
	including homes, garages, basements, sheds, boxes, pick-up truck beds, RVs, or boats. These spaces can trap poisonous gases, EVEN if you run a fan or open windows.
<b>Attach garden hose to water supply</b>	<p><b>Acquire a suitable garden hose and attach to the water supply.</b></p> <ol style="list-style-type: none"> <li>Acquire a suitable garden hose: <ol style="list-style-type: none"> <li>The water supply garden hose must have an inside diameter of at least 5/8". If the hose is more than 100 ft. long, the diameter must be at least 3/4".</li> <li>Always use a flexible rubber hose for your water supply. Do not use rigid piping.</li> <li>The use of a backflow preventer on the water supply hose is recommended and may be required by local code.</li> </ol> </li> <li>Attach garden hose to water supply.</li> </ol>
<b>Check water supply</b>	<p><b>Check adequacy of water supply.</b> Water supply should be standard tap water.</p> <ol style="list-style-type: none"> <li>Make sure the water supply is clean. Debris can cause excess pump wear and reduce performance.</li> <li>Make sure the water supply is steady and capable of flowing at a rate 20% over the rated flow of your pump. An insufficient water supply will damage your pump. Use a stopwatch to time how long it takes to fill a 5 gallon bucket with your garden hose. It should take less than 63 seconds.</li> </ol>
<b>Attach garden hose to pump</b>	<p><b>Attach garden hose to the water inlet on the pump.</b></p> <ol style="list-style-type: none"> <li>See "Machine Component Identification" section of this manual for location of water inlet.</li> <li>Confirm rubber washer and inlet screen are in the pump inlet before attaching the garden hose.</li> </ol>
<b>Attach high pressure hose</b>	<p><b>Attach the high-pressure hose to the pressure washer's water outlet.</b></p> <p><b>⚠ WARNING:</b> NEVER operate this pump with components (such as hose, connections, and spray gun) rated for lower pressure and/or temperature limits than the machine's maximum rated pressure and temperature, or component could rupture and cause serious personal injury from escaping high pressure fluids.</p> <ol style="list-style-type: none"> <li>See "Machine Component Identification" section of this manual for location of the pressure washer's water outlet.</li> <li>Your pressure washer hose is equipped with quick couplers. Simply pull the collar back and push the coupler onto the water outlet nipple. (Figure 8a). The collar should slide over the ball bearings.</li> </ol> 

## Operation

**Figure 8a**

3. Release the collar, making sure it springs back and re-seats to its original (non-retracted) position. (Figure 8b). *Check the connection by pulling on the hose to ensure a positive connection.*

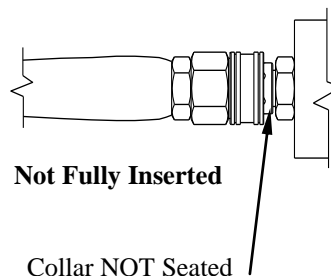
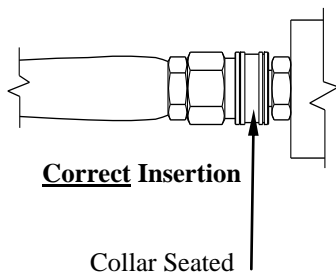

**Figure 8b**

### Select spray nozzle

**Your pressure washer is equipped with five high-pressure nozzles and one low-pressure nozzle.** Generally, the wider the spray angle of the nozzle, the lower the spray impact produced. Select the appropriate nozzle for the job based on the following table:

Color of Nozzle:	Spray Angle	Used For:
Red	0	Highest Impact
Yellow	15	Tough Stains/Stripping
Green	25	General
White	40	Light Cleaning
Black-Low pressure	65	Chemicals
Yellow	15	Steam

NOTE: You must use the black low-pressure nozzle for spraying chemicals.

### Attach nozzle

**Attach nozzle to the spray gun.**

#### **⚠ WARNING: Depressurize first**

Any time you remove/install/change a nozzle, you must depressurize hose line by squeezing the spray gun trigger while the engine is off. Even if the engine has been off for a long period of time, the hose may remain dangerously pressurized.

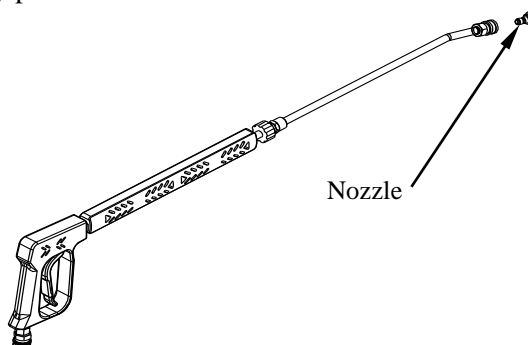

## Operation

1. Make sure the engine is off and the hose line depressurized.
2. To install the nozzle, pull the collar back and twist the nozzle firmly into the coupler on the end of the wand. (Figure 9a)

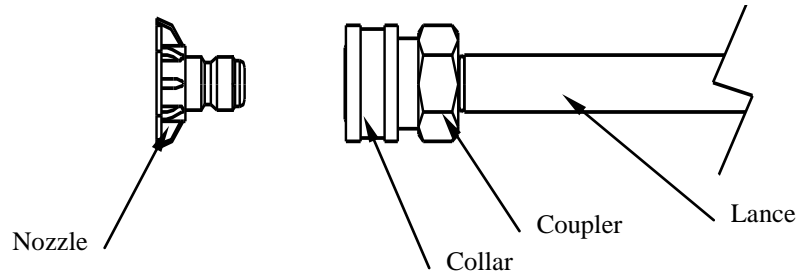

Figure 9a

3. Release the collar, making sure it springs back and re-seats to its original (non-retracted) position. (Figure 9b). *Check the connection by pulling on the nozzle to ensure a tight connection -- if correctly inserted, nozzle will rotate but not pull out.*

**⚠ WARNING:** Make sure the nozzle is correctly inserted. Sprayer nozzle can become a projectile and cause serious personal injury or property damage if not properly connected to the spray gun. Do not attempt to use different types of nozzles that may not fit the coupler.

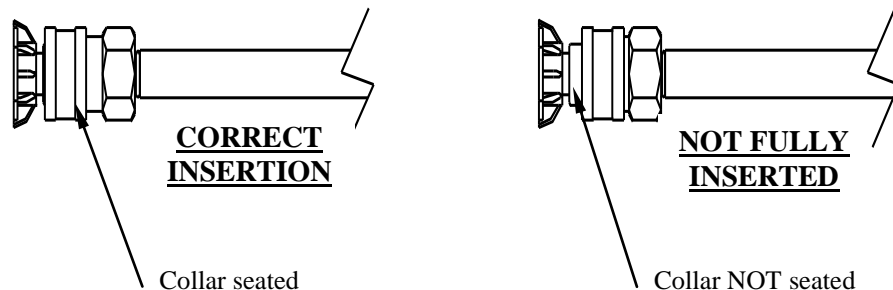

Figure 9b

### Step 2. Set Up for Chemical Spray (if desired)

Using the proper cleaning chemical for the application can speed up cleaning jobs tremendously.

**Your pressure washer is equipped with a quick connect chemical injector**, which siphons cleaning chemicals into a low-pressure washer spray downstream of the pump. Adequate suction pressure is created *only when the low pressure (black) spray nozzle* is used.

The introduction of cleaning chemicals via the chemical injector affords the following advantages:

# Operation

- It protects the pump from damage because no chemical passes through the pump.  
CAUTION: Certain chemicals, such as bleach or those containing muriatic acid, will cause pump damage if introduced upstream through the pump's water inlet.
- It mixes the cleaning chemical into a low-pressure spray. Cleaning chemicals applied under low pressure adhere better to the surface being cleaned, allowing the formula time to react and remove dirt more effectively.

Note: An external *chemical injector pump* is not recommended for use with this pressure washer.

## **⚠ WARNING: Chemical spraying**

- Never spray acids, corrosives, or abrasive or flammable liquids. Breathing hazards, surface burns/corrosion, or fire/explosion could result.
- Follow the chemical manufacturer's label instructions for proper use and handling of the chemical. Understand all safety hazards and first aid for all chemicals being used. Always wear protective gloves when handling and cleaning with chemicals, and wear other protective gear as directed by chemical manufacturer. Always dispose of hazardous fluids per local, state, and national guidelines.

### **Acquire cleaning chemical**

Use only NorthStar pressure washer chemicals or chemicals specifically formulated for use with pressure washers.

CAUTION: Non-approved chemicals can damage pressure washer components (seals, wand, hoses, pump, etc.) and be harmful to the environment.

### **Prepare for chemical spray (if planning to use)**

Prepare the pressure washer for chemical spraying using the following steps:

1. Prepare (dilute) the chemical cleaning solution as required for the job.  
(Note: The chemical injector is adjustable and will mix the chemical solution into the spray up to a maximum ratio of 1 part chemical solution to 13 parts water.)
2. Disconnect the high-pressure hose from the water outlet.
3. Snap the quick couple chemical injector onto the water outlet, then snap the high pressure hose onto the chemical injector. See Figure 10.

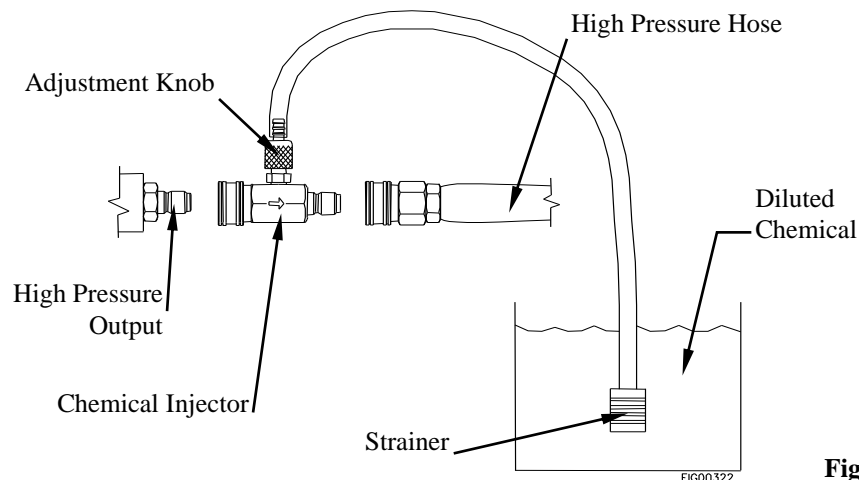

**Figure 10**



# Operation

4. Submerge the suction strainer connected to the braided chemical hose into a bucket containing the chemical solution. See Figure 10.

## Step 3. Spraying

### Safety rules for operation

**Before starting the pressure washer, review the following general safety rules for operation:**

#### Conditions for Use

**Know how to stop.** Be thoroughly familiar with proper use of the equipment and all controls and connections. Know how to stop the pressure washer and depressurize system quickly if needed (see "Step 6. Stopping").

**Instruct all operators.** The pressure washer's owner must instruct all operators and potential renters in safe set-up and operation. Do not allow anyone to operate the pressure washer who has not read the Owner's Manual and been instructed on its safe use.

**Adult control only.** Only trained adults should set up and operate the pressure washer. Do not let children operate. Pressure washers can generate forces greater than children can control and require judgment beyond what can be expected of children.

**Under the influence.** Never operate, or let anyone else operate, the pressure washer while fatigued or under the influence of alcohol, drugs, or medication.

**Safety equipment / controls in place.** Do not operate the pressure washer unless all safety covers, guards, and barriers are in place and in good working order, and all controls are properly adjusted for safe operation.

**Damaged.** Do not operate the pressure washer with damaged, missing, or broken parts. Never attempt to repair a high pressure hose or component. Always replace it with a part that is rated at or above the pressure rating of the machine.

**Modifications.** Do not modify the pressure washer in any way or deactivate any safety device. Do not change or add to fuel tank, fuel lines, or exhaust system. Modifications can result in hazards related to carbon monoxide poisoning, fuel leaks, fire, explosion or other serious safety hazards, and will also void the warranty.

#### During Use

**Stay alert.** Watch what you are doing at all times.

**Clear work area.** Clear the work area of all bystanders. Keep children and pets away.

**Keep spray away from electrical wiring.** Spray contact with electrical wiring will likely result in severe electrical shock or electrocution.

**Hot exhaust/parts.** Stay clear of engine and burner exhausts. Never touch hot engine muffler, burner/heating coil, or other hot surfaces. All are very hot and will burn you.

**Do not direct spray at this machine.** Do not attempt to clean this machine with its own spray. Engine damage will result. Cleaning should be done with a damp sponge with the engine OFF.

**Let engine cool** at least two minutes before refueling.

**Avoid inhalation of exhaust.** This product emits CO and chemicals known to the State of California to cause cancer, birth defects or other reproductive harm.

**Never pull by hose.** Do not move this machine by pulling on the hose. Hose or connections could fail and result in catastrophic high pressure release of fluid as well as hose whipping.

**Avoid sharp objects.** Keep hose away from sharp objects. Bursting hoses may cause

## Operation

	<p>injury.</p> <p><b>No load bearing.</b> Do not use the pump to support other items of equipment that impose unacceptable loads on the pump. Do not attempt to use this machine as a prop.</p> <p><b>Lock trigger safety latch when not spraying.</b> Spray gun is equipped with a built-in trigger safety latch to guard against accidental trigger release. Rotate safety latch to the locked position when not spraying.</p> <p><b>Leaving unattended.</b> Always turn off the pressure washer and relieve system pressure before leaving the sprayer unattended.</p> <p style="text-align: center;"><b><u>Prompt Emergency Response</u></b></p> <p><b>Seek medical aid for suspected injection injury.</b> If injured by high-pressure fluid, no matter how small the wound is, see a doctor at once. A typical injection injury may be a small puncture wound that does not look serious. However, severe infection or reaction can result if proper medical treatment is not administered immediately by a doctor who is familiar with injection injuries.</p> <p><b>Seek medical aid for suspected carbon monoxide poisoning.</b> The running engine gives off carbon monoxide, a poisonous gas that can kill you. If you start to feel sick, dizzy, or weak while using the pressure washer, shut off the engine and get to fresh air RIGHT AWAY. See a doctor. You may have carbon monoxide poisoning.</p>
<b>Put on personal protective gear</b>	<p> <b>WARNING:</b></p> <p>Use personal protective gear to prevent:</p> <ul style="list-style-type: none"> <li>- Eye and skin injection injury from high pressure spray</li> <li>- Burns from hot water or steam</li> <li>- Eye injury from flying debris</li> </ul> <ol style="list-style-type: none"> <li>1. Wear waterproof, thermally insulated gloves, safety glasses with side and top protection, face protection, and protective clothing when operating the machine. If spraying pressure washer specific chemicals, wear a respirator mask to avoid inhalation of vapors if directed on the chemical label.</li> <li>2. Wear non-slip, protective footwear. Use of pressure washer can create puddles and slippery surfaces. Wear footwear capable of maintaining a good grip on wet surfaces.</li> </ol>
<b>Prime the water supply</b>	<p><b>Turn on water supply and squeeze the trigger.</b></p> <p><b>CAUTION:</b> Never run the pump without the water supply connected and turned on. Operating the pressure washer without a sufficient incoming flow of water will damage the pump.</p> <ul style="list-style-type: none"> <li>• Turn on the water supply. Make sure the water supply is steady and flowing at a rate 20% over the rated flow of your pump. (See Step 1, "Connect Hoses, Water Supply, and Nozzle").</li> <li>• Purge air from the water supply hose by squeezing the trigger until a steady stream of water flows out of the nozzle at low pressure. (Air in the hoses can cause damage to the pump, so always make sure all the air is out of the hoses before starting the pressure washer engine.)</li> <li>• Make sure the water supply hose is not kinked. A kinked hose will provide insufficient water supply to the pump and reduce its life. Make sure the hose remains unkinked after moving the pressure washer.</li> </ul>

## Operation

<b>Start engine</b>	<p><b>Start the engine to power the pump.</b></p> <ol style="list-style-type: none"> <li>1. Make sure water supply is connected and primed. CAUTION: Running the pump dry will cause damage and void the warranty.</li> <li>2. To prevent accidental spraying, engage the safety latch on spray gun trigger by rotating it to the locked position.</li> <li>3. Follow the instructions in the Engine Manual for starting the engine. - If the engine doesn't start on the first try, pressure may build up in the pump. Relieve pressure by squeezing the spray gun trigger before attempting to start engine again. This will make starting easier.</li> </ol> <p><b>⚠ DANGER:</b> Do not inhale engine exhaust. It contains dangerous carbon monoxide that can kill you.</p>
<b>Apply cleaning chemical</b> (if desired)	<p><b>If desired, spray cleaning chemical at low pressure</b> (with or without heated water).</p> <ol style="list-style-type: none"> <li>1. Make sure the chemical injector is properly set up according to the instructions in Step 3, "Set Up for Chemical Spraying".</li> <li>2. Make sure the low pressure BLACK nozzle is attached before beginning to spray chemicals -- <i>Only the low pressure black nozzle will allow chemicals to be drawn through the chemical injector into the water stream.</i></li> <li>3. You can apply chemicals with either warm or cold water. Check chemical label. If warm water is specified, start burner according to instructions provided below.</li> <li>4. Apply chemicals by squeezing the spray gun trigger. The chemical injector will draw the chemical into the water stream.</li> <li>5. The chemical concentration of the spray can be changed by turning the chemical adjustment knob located on the chemical injector.</li> <li>6. Apply chemicals evenly to the cleaning surface. Never use more chemical than is necessary to clean the surface.</li> <li>7. Allow the chemicals time to react with the dirt before rinsing.</li> <li>8. Prepare to rinse by changing to a high-pressure nozzle. Changing the nozzle from the low-pressure black nozzle to a high-pressure nozzle will stop the flow of chemicals into the water stream. <i>Refer to instructions for selecting and changing the nozzle in Step 1, "Connect Hoses, Water Supply, and Nozzle".</i></li> <li>9. Rinse with high-pressure spray, either hot or cold, as instructed below.</li> </ol>
<b>Turn on burner</b> (If hot spray or steam is desired)	<p><b>If HOT spray or steam is desired, turn on the burner:</b></p> <ol style="list-style-type: none"> <li>1. First make sure vicinity is free of flammable vapors, dust, gases, or other potentially combustible materials. Operate only where open flame or torch is permitted.</li> <li>2. Make sure there is fuel in the burner fuel tank.</li> </ol>

# Operation

	<p>CAUTION: Do not run the machine in hot mode without fuel in the burner's fuel tank, or damage can occur.</p> <p>3. Make sure the engine throttle is all the way open. If it is not, the engine will not supply adequate voltage to the burner, resulting in smoke coming from the heat exchanger during operation.</p> <p>Turn the heat switch ON and adjust the thermostat to the desired temperature. (For steam spraying, set the temperature at 212°F or higher and use yellow steam nozzle.)</p> <p><b>⚠ WARNING:</b></p> <ul style="list-style-type: none"> <li>• NEVER attempt to immediately run or re-light the burner if it doesn't ignite the first time. Unburned oil or gas may have accumulated, causing potential explosion or fire hazard.</li> <li>• Do not attempt to set temperature limit above the preset limit.</li> <li>• Never touch hot burner surfaces and stay clear of burner exhaust. All are very hot and will burn you.</li> <li>• Do not inhale burner exhaust. It contains dangerous carbon monoxide that can kill you.</li> </ul> <p>4. The burner will fire when the trigger is squeezed – follow instructions for spraying.</p> <p><u>Note:</u> If burner exhaust is white, adjust burner for peak performance. See the "Oil Burner Adjustment Instructions" step in the "Set-Up" section of this manual.</p> <p>5. When the trigger is released, a pressure switch automatically turns the burner off. Also, when the temperature setting is reached, the thermostat automatically turns the burner off.</p> <p><b>⚠ WARNING:</b> It is important that the burner stops firing when the trigger is released. If the burner remains firing, discontinue use until the pressure washer is serviced. Extremely high temperatures can result in serious injury and equipment damage.</p>
<p><b>Begin high pressure spray</b></p>	<p><b><u>High Pressure Spray Procedure</u></b></p> <p><b>⚠ WARNING: High pressure spraying safety</b></p> <ul style="list-style-type: none"> <li>• <b>Keep spray away from people.</b> Never direct discharge stream at or near any person. Do not allow any part of the body to come in contact with the fluid stream. High-pressure spray can cause serious skin, eye, or falling injuries, and hot water can burn. Injection injury will occur if high-pressure spray pierces the skin, injecting liquid under the skin. Injection injury can result in blood poisoning and/or severe tissue damage leading to infection, gangrene and possibly amputation. Seek medical attention.</li> <li>• <b>Do not secure trigger open.</b> To reduce risk of injury, do not attempt to secure the spray gun open by blocking or tying the spray gun in the open position.</li> <li>• <b>Prevent slips / loss of balance.</b> High-pressure spray could cause you to lose</li> </ul>

# Operation

balance from kickback forces, and wet surfaces can be slippery.

- Keep good footing and balance at all times. Do not overreach.
  - Do not stand on unstable support when spraying.
  - If spraying from an elevated surface, use fall protection because spray gun kickback can propel you off the elevated surface. When spraying from a ladder or scaffolding, ensure it is firmly anchored from sway or tip-over.
  - Be aware of puddles and slippery surfaces. Ensure there is adequate drainage to prevent pooling of water.
- **Prevent surface damage & flying debris** – Surfaces being sprayed must be strong enough to withstand high-pressure spray or damage may result. In addition, high-pressure spray will dislodge unsecured objects as well as surface chips and debris, resulting in hazardous flying objects that can cause personal injury or property damage. Do not spray brittle surfaces or breakable, fragile, or unsecured objects such as:
    - stucco or laminar flagstone
    - some painted surfaces
    - windows or glass doors (because they may break)
    - light fixtures, flowerbeds, mailboxes
    - unsecured, lightweight objects

## Procedure:

1. Put on one of the high-pressure spray nozzles (always relieve system pressure first and follow instructions for attaching a nozzle).
2. Clear the cleaning area of all persons. Keep children and pets away.
3. Hold the spray gun firmly with two hands and a sturdy stance -- Gun kicks back when triggered.

 **CAUTION:** Spray gun metal gets extremely hot when using the burner and can burn you on contact. Never touch the metal screw or any metal parts of the spray gun when the heater is being used. Use only designated grip areas.

4. Wash from the bottom to the top, using side-to-side motions. This washes away heavy dirt and allows the detergent to soak as you work towards the top.
5. Use the width of the spray pattern to wash a wide path. Overlap spray paths for complete coverage.
6. The nozzle should be 12" to 24" from the work, closer for tough areas.
7. Small parts should be washed in a basket so the pressure does not push them away. Larger, lightweight parts should be clamped down.
8. The pressure washer is set and locked to the maximum rated pressure when it leaves the factory. To reduce the pressure, turn the unloader knob counterclockwise. (See Figure 11 on next page)

## Operation



**WARNING:** Do not attempt to alter the unloader valve's maximum pressure. Excess pressure could cause serious injury from escaping high-pressure fluids and/or pump damage. Any alteration other than turning the adjustment knob will void your warranty.

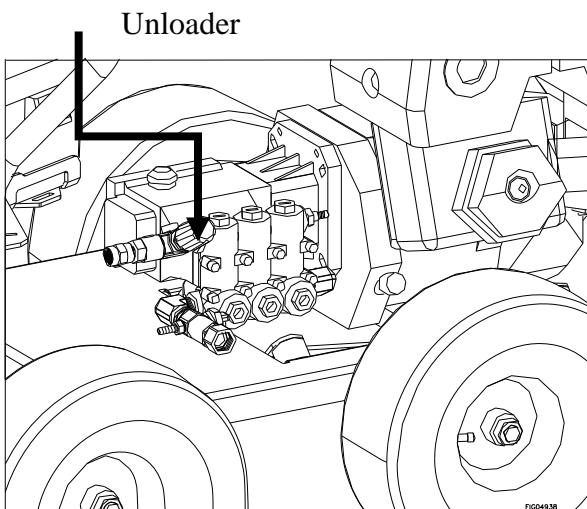

**Figure 11**

If temporarily interrupting spraying, rotate trigger safety latch downward to the locked position to guard against accidental trigger release.

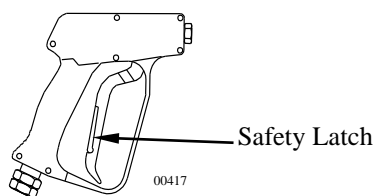

9. Always turn off the engine and activate spray gun trigger to relieve system pressure when:
  - the sprayer is unattended, or
  - disconnecting hoses, installing/cleaning nozzles, or servicing the pump.



**WARNING:**

Always turn off the engine and relieve system pressure when finished spraying or when leaving sprayer unattended. Serious injury could result from unintentional release of high-pressure spray.

# Operation

## Step 4. Stopping

Stop the engine using the following steps:

**⚠ WARNING:**

Never disconnect the high-pressure hose from the pump or spray gun while the system is pressurized. Relieve pressure by squeezing the spray gun trigger after the engine is turned OFF.

1. If the heater was used, turn heat switch OFF and run cold water through the coil for at least 3 minutes while spraying.
2. Turn engine OFF.
3. Turn water supply OFF.
4. *Actuate spray gun trigger to relieve system pressure.*
5. Remove garden hose.
6. Remove pressure hose. If chemicals were used, remove quick connect chemical injector from the pressure hose and water outlet.
7. Remove nozzle from spray gun.
8. Turn gasoline line valve to the OFF position.
9. Cool engine at least five minutes before storing -- A hot engine is a fire hazard.

## Storage

When you are finished using the pressure washer, you must prepare the sprayer for storage and store it in a proper location. Note:

- **If you will be storing the sprayer in freezing conditions**, follow the instructions for preparing the sprayer for storage in freezing conditions.
- **If you will not be using the sprayer again for 30 days or more**, follow the instructions for preparing the engine for long-term storage.

**⚠ WARNING**

- **Fuel and its vapors can ignite and cause a fire.** Select a well-ventilated storage area away from sources of heat, flame, or sparks.
- **A hot engine can ignite flammable materials.** Always let engine cool at least five minutes before storing.

Detailed instructions are provided on the next page.

## Storage

<b>Choose a storage location</b>	<b>Choose a storage location that is:</b> <ul style="list-style-type: none"> <li>○ Clean and dry.</li> <li>○ Away from sources of heat, open flames, sparks, or pilot lights, even if the pressure washer's engine and burner fuel tanks are empty. Residual fuel fumes from tank can ignite.</li> <li>○ Away from extreme high or low temperatures. Do not store the pressure washer in freezing conditions unless it is prepared as directed below for those conditions.</li> </ul>
<b>Perform regular maintenance</b>	<b>Perform periodic maintenance</b> as directed in this manual to keep the pressure washer in safe working condition.
<b>Prepare pressure washer for freezing conditions</b> (if needed)	<p><b>If you will be storing the pressure washer in freezing temperatures, you must properly prepare the pressure washer to prevent water from freezing in the system.</b></p> <p><b>⚠ CAUTION:</b> Do not allow water to freeze in the pressure washer, high pressure hose, or spray gun. Freezing water can cause damage to the equipment and cause the spray gun to fail in the open position. A spray gun that has failed in the open position can whip around and cause personal injury when the pressure washer is started.</p> <div data-bbox="763 1131 1190 1604" data-label="Image"> <p>The diagram illustrates the process of adding antifreeze to the pressure washer's water inlet. A container labeled 'RV Antifreeze' is shown pouring the liquid through a 'Funnel' into the 'Hose', which is connected to the 'Water Inlet'.</p> </div> <p style="text-align: right;"><b>Figure 12</b></p> <p>Drain the water from the high-pressure hose and spray gun by depressing the trigger on the spray gun until all water drains out.</p> <ol style="list-style-type: none"> <li>1. Using a wrench, disconnect the plumbing that connects to the pump outlet.</li> <li>2. Obtain the materials you will need:             <ul style="list-style-type: none"> <li>• 12" piece of garden hose or equivalent</li> <li>• funnel</li> <li>• approximately 6 oz. of RV antifreeze.</li> </ul> </li> </ol>



## Storage

	<p>3. Attach the 12" garden hose piece with the funnel to the pump inlet. Pour RV antifreeze into the funnel, then turn starter (or pull the recoil) a few times until antifreeze comes out of the pump outlet.</p>
<p><b>Prepare engine for long term storage</b> (if storing more than 30 days)</p>	<p><b>First prepare the engine for long term storage if you will not be using the pressure washer again for more than 30 days.</b></p> <p>Fuel can become stale when stored over 30 days. Stale fuel causes acid and gum deposits to form in the fuel system which can cause malfunction of the engine.</p> <p>1. Prepare fuel system for storage:</p> <ul style="list-style-type: none"> <li>○ <b>Drain all gasoline</b> from the tank and carburetor. This is most easily accomplished by <i>running the pressure washer with the high pressure hose</i> until the engine stops from lack of fuel.</li> </ul> <p><b><u>OR</u></b></p> <ul style="list-style-type: none"> <li>○ <b>Add fuel stabilizer</b> to the gasoline (following manufacturer's instructions)</li> </ul> <p style="padding-left: 40px;"><u>Fuel stabilizer steps:</u></p> <ul style="list-style-type: none"> <li>a. Ensure gas tank is full.</li> <li>b. Add fuel stabilizer to fuel tank.</li> <li>c. <i>Run pressure washer with high pressure hose</i> at least 5 minutes after adding stabilizer to allow it to enter the fuel system.</li> <li>d. Shut off engine</li> </ul> <p>2. Lubricate cylinder and piston:</p> <ul style="list-style-type: none"> <li>a. Disconnect spark plug wire and remove spark plug</li> <li>b. Add one teaspoon oil through spark plug hole</li> <li>c. Place rag over spark plug hole and turn starter (or pull the recoil) a few times to lubricate the combustion chamber.</li> <li>d. Replace spark plug, but do not reconnect the spark plug wire.</li> </ul>
<p><b>Prepare pressure washer for storage</b></p>	<p><b>Prepare the pressure washer for storage.</b></p> <ol style="list-style-type: none"> <li>1. Disconnect the battery, remove it from the battery compartment, and store it indoors.</li> <li>2. Make sure the engine start switch is OFF and fuel valve is OFF.</li> <li>3. Disconnect the engine spark plug wire if you haven't already done so.</li> <li>4. Disconnect the high-pressure hose, garden hose, and spray gun.</li> </ol>
<p><b>Move pressure washer to storage location</b></p>	<p><b>Let engine cool for 5 minutes</b> before moving the pressure washer to it's storage location.</p>

# Burner Adjustment

## Oil Burner Adjustment

(only needed if white exhaust smoke appears)

The oil burner is preset and performance tested at the factory (elevation 1100 feet). Different altitudes may require a one-time initial burner adjustment.

### ⚠ CAUTION:

If white smoke appears from the burner exhaust vent during start-up or operation, discontinue use and readjust air bands.

Specific steps for burner correction are given below.

### Burner Correction

Adjusting the burner will require you to access the burner from underneath the pressure washer while someone else is operating the spray gun.

Detailed instructions:

1. Make sure burner is cool to the touch before attempting to adjust.

**⚠ WARNING:** The burner adjustment procedure requires part of an individual's body to be underneath the pressure washer while it is elevated. Always ensure the pressure washer is securely elevated before working on the burner underneath.

2. Locate the air intake adjustment band as shown in Figure 13 below. Observe the position of the arrow on the air band relative to the calibration numbers directly to the right. (Note: Factory calibration starts out at close to "1".)

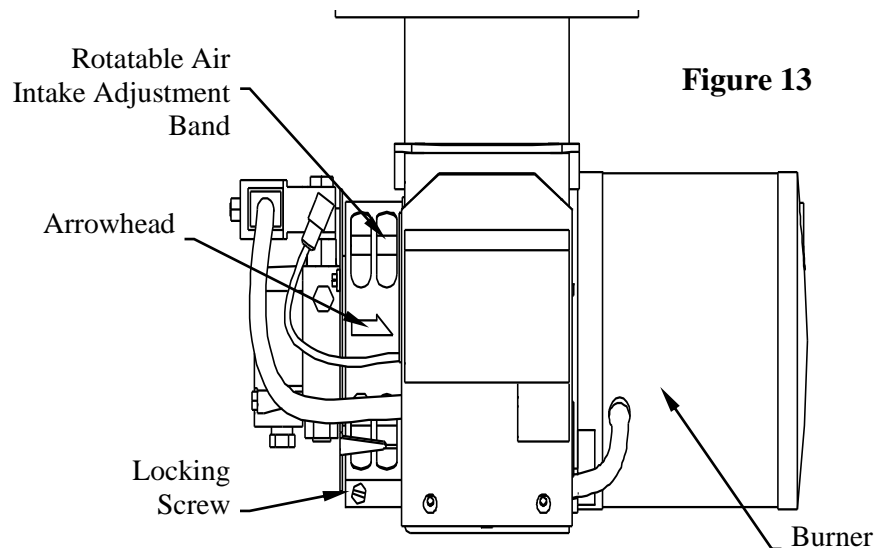

3. Loosen the locking screw and rotate the air band closed until black smoke appears from the burner exhaust vent. Note which number the arrow now points to.
4. Slowly open the air band until white smoke just starts to appear.
5. Turn air band halfway back to the black smoke position previously noted. Tighten the locking screw.

## Burner Adjustment

6. Now fine tune the burner air by adjusting the shutter:
  - a. Locate the shutter as shown in Figure 14 below. The shutter is a thin circular metal plate located on the outside of the air band. The shutter adjusts independently from the air band and is used to fine-tune the amount of intake air.
  - b. Observe that the aluminum pointer attached to the shutter. It points to the same set of calibration numbers as the air band arrow. Observe which number it points to at the start of this adjustment step.
  - c. Loosen the shutter lock screw. Turn the shutter using the aluminum pointer until the exhaust is cleanest. Tighten the shutter lock screw.

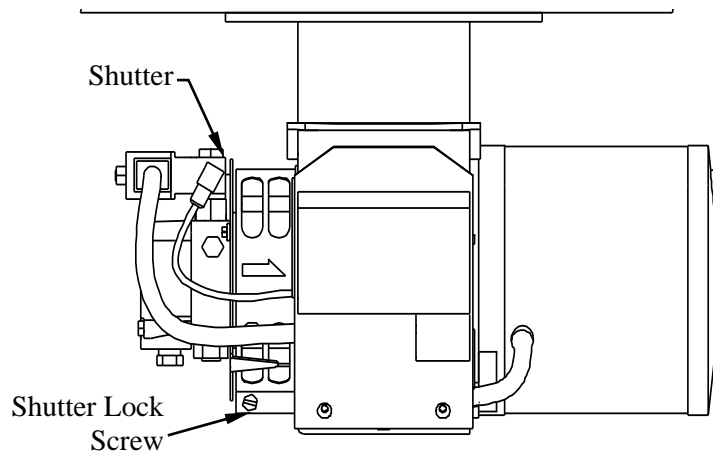

**Figure 14**

# Maintenance and Repair

Inspect and maintain your pressure washer as specified below in order to keep it in safe and optimal working order. Follow all safety rules and recommended maintenance instructions.

## WARNING

ALWAYS shut off water supply, bleed water pressure, turn off engine and disconnect the spark plug before cleaning, adjusting, or servicing the pressure washer. After servicing, make sure all guards and cover shields are replaced before using.

## Maintenance Schedule

Item	Frequency
Remove dust/debris accumulation	As needed
Inspect fuel system	Each use
Inspect spray system	Each use
Clean inlet filter	Each use
Check tire pressure	Each use
Recharge and maintain battery	As specified in Battery Manufacturer's instructions
Perform engine maintenance	As specified in Engine Owner's manual
Change pump oil	<ul style="list-style-type: none"> <li>• After first 40 hours of use</li> <li>• Every 3 months or 500 hours of use after that</li> </ul>
Maintain burner's fuel filter / water separator	<ul style="list-style-type: none"> <li>• Drain water as needed</li> <li>• Change filter after every 500 hours of use</li> </ul>
Descale coil	Annually, or more frequently as use and performance require (see instructions)
Inspect and desoot coil if needed	Annually
Inspect/clean/adjust electrodes	Annually

**See detailed instructions for each maintenance item below.**

(Note: For end-of-the-season storage instructions, see the "Storage" section of this manual.)

## Maintenance & Repair-Detailed Instructions

### Follow safety rules

**Read and follow these safety rules whenever you will be servicing the pressure washer:**

- **Turn off / relieve pressure first.** Always turn off pressure washer and relieve system pressure before inspection or maintenance. Remove spark plug or spark plug wire to prevent accidental starting.
- **Fuel valve off.** Turn fuel shut-off valve to OFF position before transporting or servicing the pressure washer.
- **Replace guards.** Make sure all guards and cover shields are replaced after servicing the pressure washer.
- **Major repair.** Major service, including the installation or replacement of parts, should be performed only by a qualified electrical service technician. Obtain factory approved parts from Northern Tool Product Support at 1-800-270-0810.
- **Replacement parts.** If a part needs replacement, only use factory approved

## Maintenance and Repair

	<p>repair parts. Replacement parts that do not meet specifications may result in a safety hazard or poor operation of the pressure washer and will void the warranty.</p>
<b>Keep pressure washer clean</b>	<p><b>Keep pressure washer clean.</b> If dust or debris accumulates on the pressure washer, clean the pressure washer with a damp cloth or soft bristle brush. Do not allow air intakes to become blocked.</p> <p><u>CAUTION:</u> Do not spray pressure washer with a garden hose or pressure washer. Water may enter the pressure washer and cause damage.</p>
<b>Inspect fuel system(s)</b>	<p><b>Inspect the fuel systems (of both engine and burner) and check for leaks before each use.</b> Do not start pressure washer until all needed repairs have been completed.</p> <p><b>⚠ WARNING:</b> Fuel leak hazard Gasoline and burner fuel are highly explosive and fuel leaks can result in fire or explosions. You can be burned and seriously injured if the fuel system is not properly hooked up or there is a fuel leak when you start the engine.</p> <p>Inspect the entire fuel system, for both engine and burner. Look for:</p> <ul style="list-style-type: none"> <li>• signs of leaks or deterioration,</li> <li>• chafed or spongy fuel hose,</li> <li>• loose connections,</li> <li>• loose or missing fuel hose clamps,</li> <li>• damaged fuel tank, or</li> <li>• defective gasoline shut-off valve.</li> </ul>
<b>Inspect spray system</b>	<p><b>Inspect spray system for damage and leaks before each use.</b> Do not start pressure washer until all needed repairs have been completed.</p> <p><b>⚠ WARNING:</b> High pressure fluid injection hazard High pressure fluid discharge from leaks (even pin-sized) or ruptured components can pierce skin and inject fluid into the body. Injection injury can result in blood poisoning and/or severe tissue damage leading to infection, gangrene, and possibly amputation.</p> <ul style="list-style-type: none"> <li>• Never use a finger or skin to check for leaks.</li> <li>• Never operate machine with damaged or missing hoses/parts.</li> <li>• Never attempt to repair a high-pressure hose or component – Always replace it with a part that is rated at or above the pressure rating of this machine.</li> </ul> <p>1) Check hoses, fittings, wand, trigger gun and connections for signs of wear, cracks, looseness, or leaks. Replace as required.</p> <p>2) Check and clean the nozzle orifice.</p>

## Maintenance and Repair

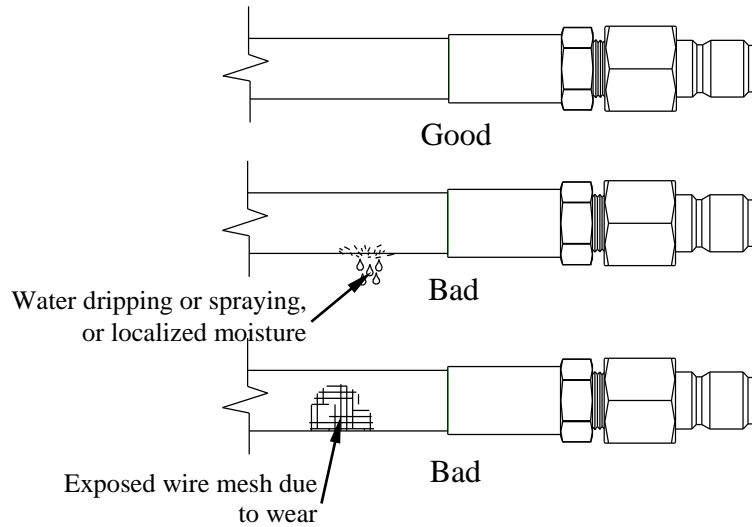

**Figure 15**

### Clean inlet filter

**Clean the inlet filter before each use.**

#### **⚠ WARNING:**

When cleaning filters, check whether dangerous chemicals have been used with the filter and take any precautions that may be recommended by the manufacturer of these chemicals. Always dispose of hazardous fluids per local, state, and national guidelines.

- 1) Unscrew garden hose from water inlet (if connected).
- 2) Unscrew inlet filter.
- 3) Remove filter screen.
- 4) Run water through filter screen to clean.
- 5) Reassemble

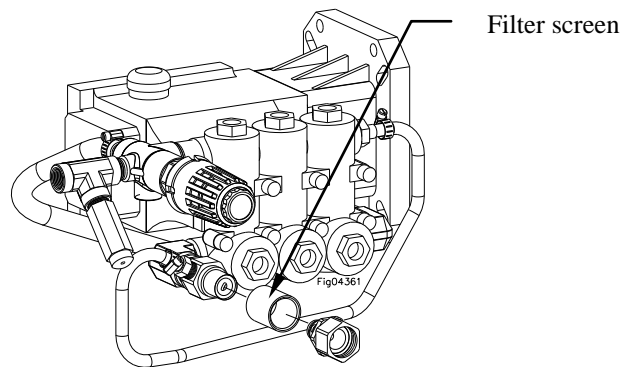

### Check tire pressure

**Check and refill tire pressure before each use.**

- 1) Remove air cap on tire.
- 2) Check tire pressure.
- 3) If needed, fill tire to 30 psi (2.07 bar). Do not overinflate.
- 4) Replace air cap.

## Maintenance and Repair

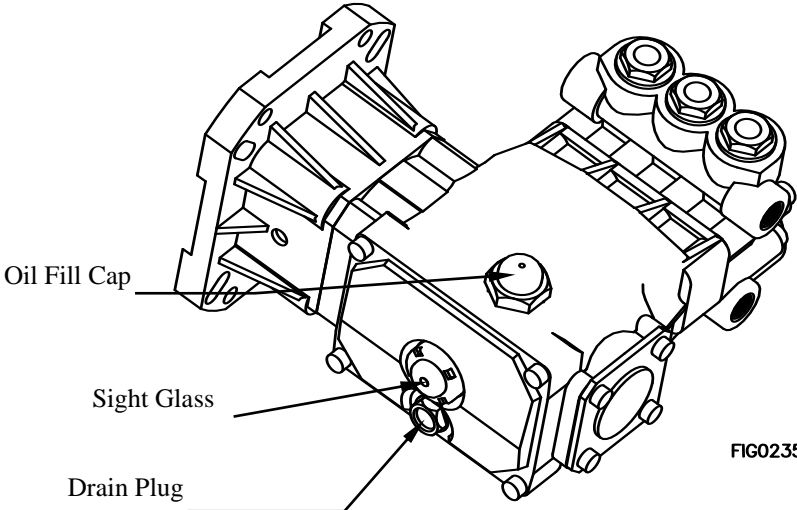
<b>Recharge and maintain battery</b>	<p><b>Inspect, recharge, and maintain battery according to your battery manufacturer's instructions.</b></p> <p>Do not store with battery charger always connected. Batteries that are over-charged can boil themselves dry and produce excessive amounts of hydrogen, an explosive gas.</p>
<b>Perform engine maintenance</b>	<p><b>Perform engine maintenance as specified in the engine owner's manual.</b></p> <p>Engine maintenance items include:</p> <ol style="list-style-type: none"> <li>1. Changing oil and oil filter</li> <li>2. Air filter check/replacement</li> <li>3. Spark plug cleaning and replacement</li> <li>4. Fuel filter check/replacement</li> <li>5. Inspecting and cleaning muffler (and spark arrestor if equipped)</li> </ol>
<b>Change pump oil</b>	<p><b>Change the pump oil</b> after the first 40 hours of use, and then after every 3 months or 500 hours of use after that.</p> <ol style="list-style-type: none"> <li>1. Remove drain plug from pump.</li> <li>2. Drain pump oil into suitable container and dispose of responsibly.</li> <li>3. Reinstall oil drain plug.</li> <li>4. Make sure unit is sitting level. Fill pump with 18 oz. of SAE30 non-detergent oil or Cat Pump Oil Item #22158 to middle of sight glass (or at the indicator line on the dip stick if equipped).</li> <li>5. Replace oil fill cap.</li> </ol> <div style="text-align: center;">  <p>The diagram shows a side view of a pump assembly. Three components are labeled with leader lines: 'Oil Fill Cap' at the top left, 'Sight Glass' in the middle, and 'Drain Plug' at the bottom. The pump has various ports and a complex housing. The label 'FIG02358' is located at the bottom right of the diagram.</p> </div> <p style="text-align: center;"><b>Figure 16</b></p>

## Maintenance and Repair

### Maintain burner's fuel filter/water separator

**Drain water from burner's filter bowl as needed, and replace filter after every 500 hours of use or as needed.**

- 1) After each use of the burner, visually check the filter bowl. If any water has accumulated, drain it via the water drain at the bottom of the bowl.
- 2) After every 500 hours of operation, empty the burner's fuel tank in order to remove the filter bowl and inspect the fuel filter/water separator. Replace filter as needed.

***Important:** Always empty the burner's fuel tank before removing the filter bowl. There is no shut-off valve between fuel filter/water separator and burner's fuel tank.*

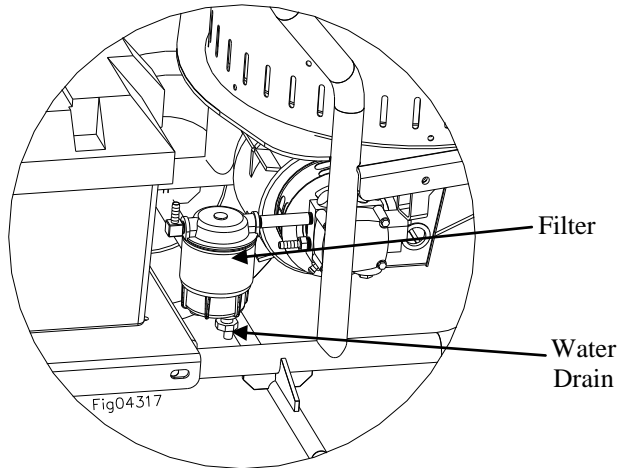

**Figure 17**

### Descale heating coil

**Descale coil tubing annually or more frequently as needed.**

In hard water areas, scale can build up inside the heating coil tubing. Scale deposits will decrease the output pressure and temperature of heated spray, and may eventually clog water flow through the heating coil.

Descale the coil tubing at least annually and more frequently if you detect a decrease in output pressure or temperature.

To descale the coil:

- 1) Mix a commercial coil cleaner in a 5-gallon bucket and elevate the bucket so it is higher than the unloader.
- 2) Attach the high-pressure hose(s) to the high-pressure water outlet on the machine. Do not hook up the spray gun.
- 3) Place the other end of the high-pressure hose(s) in the 5-gallon bucket.
- 4) Attach a short length of garden hose to the garden hose inlet on the pump.
- 5) Prime the pump by filling the hose with water, then placing the end of the hose in the bucket.
- 6) Run the pressure washer in cold mode for 1 to 3 hours, recirculating the cleaning solution. **CAUTION:** Do not run the burner.



## Maintenance and Repair

- 7) Dispose of the cleaning solution where it is not harmful to animals or the environment.
- 8) Flush with fresh water and clean the inlet strainer when finished.

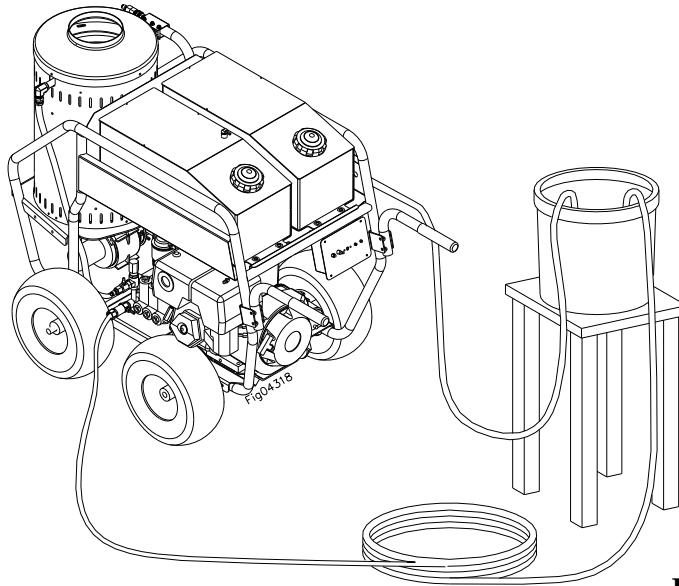

**Figure 18**

### Cleaning Flow Switch

#### **Inspect and clean the flow switch as needed**

Mineral build-up and/or debris within the flow switch can occur and may affect burner operation if not periodically cleaned. Mineral build-up and/or debris can stop the movement of the shuttle inside the flow switch body. Shuttle movement is important because the burner will not fire if the shuttle does not move. The shuttle movement actuates a switch inside the flow switch housing which allows the burner to fire during spray mode.

- 1) Disconnect the swivel fitting from elbow to the inlet of the coil
- 2) Disconnect the whole flow switch assembly including the swivel and removable outlet fitting where the brass body connects to hose or tee depending on model

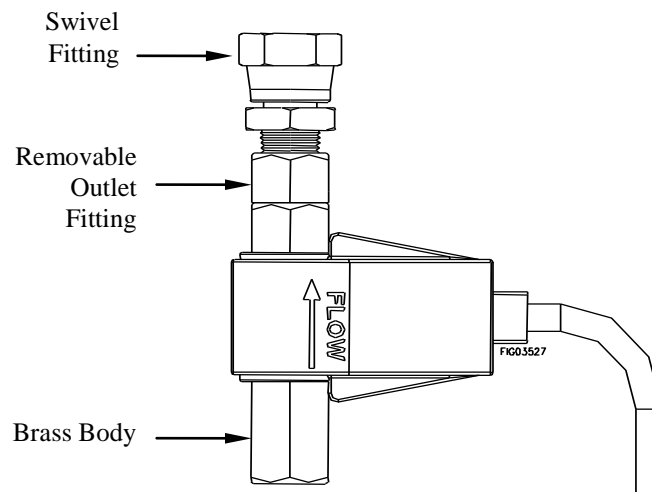

**Figure 19**

## Maintenance and Repair

- 3) Unthread the removable outlet fitting with the swivel still attached from the flow switch assembly
- 4) Remove the shuttle
- 5) Clean the inside of the brass flow switch body and the shuttle with water and a soft brush
- 6) Insert the shuttle into the brass flow switch in the orientation shown  
*Note: Aligning the male tabs on the shuttle to the female guides inside the brass flow switch body can be difficult since the shuttle is magnetic*
- 7) Thread the removable outlet fitting with the swivel still attached into the flow switch assembly
- 8) Thread the brass flow switch body onto the incoming water flow source (hose or tee) depending on the model
- 9) Reconnect the swivel fitting to the inlet of the coil

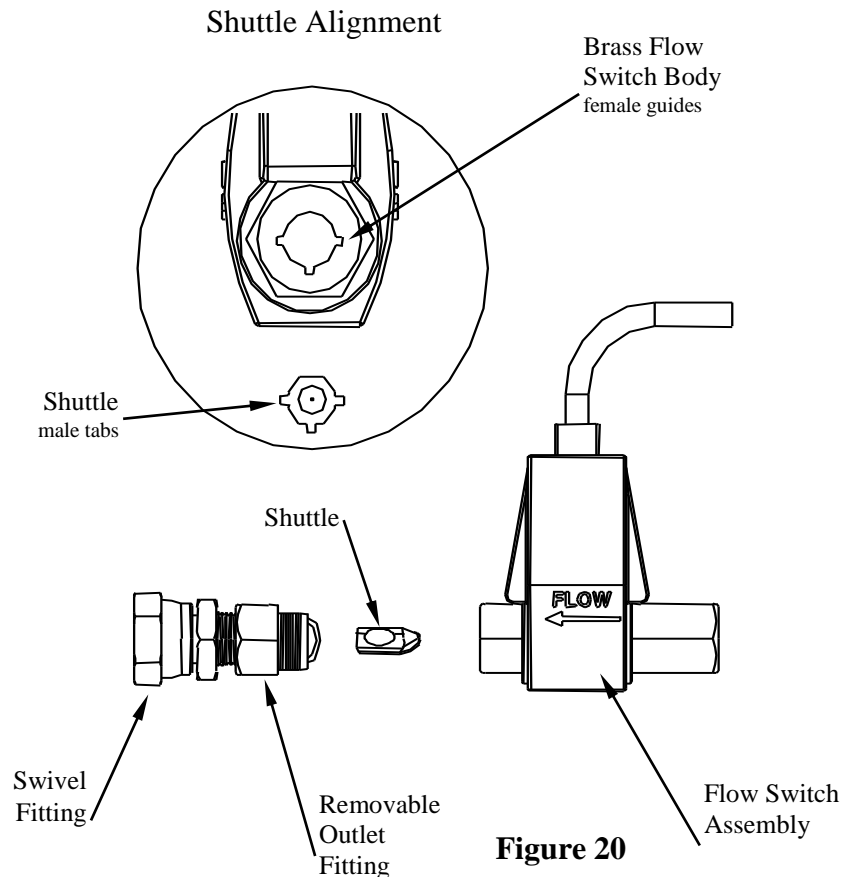

### **Inspect heating coil and desoot as needed**

#### **Inspect and desoot coil annually.**

Most coils never require desooting. However, poor grades of fuel oil or inadequate combustion air will cause heavy soot build-up on the outside surface of the heating coil tubing. These deposits will insulate the coil, which then restricts air flow through the heat exchanger and further aggravates the soot build-up.

If soot has built up on the exterior of the coil tubing, clean as follows:

## Maintenance and Repair

- 1) Wear protective clothing, goggles, and gloves.
- 2) Disconnect high-pressure hose on inlet side of coil and thermostat on outlet side of coil.
- 3) Remove the lid and insulation lid from the heating chamber and hoist the coil out. Be careful, the coil weighs 125 lbs.
- 4) Clean the coil.
- 5) Reassemble the coil and lids to the machine. Make sure the white insulation remains in place.
- 6) Reattach high-pressure hose and thermostat and make sure all fittings are tight before using the machine.

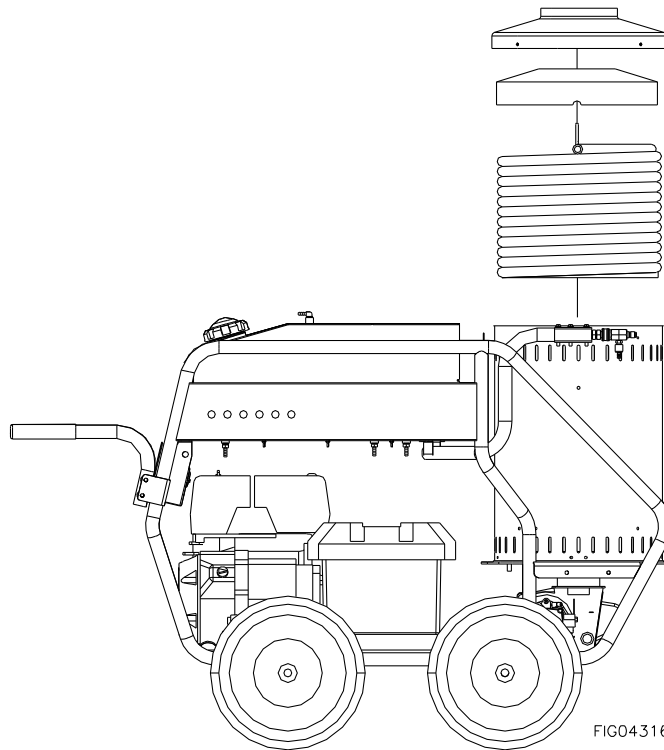

**Figure 21**

### **Inspect electrodes**

**Inspect electrodes yearly and make adjustments as needed.**

- 1) Remove the 4 nuts that attach the burner to the heating chamber. You do not have to disconnect the fuel lines or the electric cords.
- 2) Pull the burner out from underneath the heat exchanger.
- 3) Clean off carbon deposits, which may have accumulated on the tips of the electrodes.
- 4) Reset the spacing as shown in Figure 22.

## Maintenance and Repair

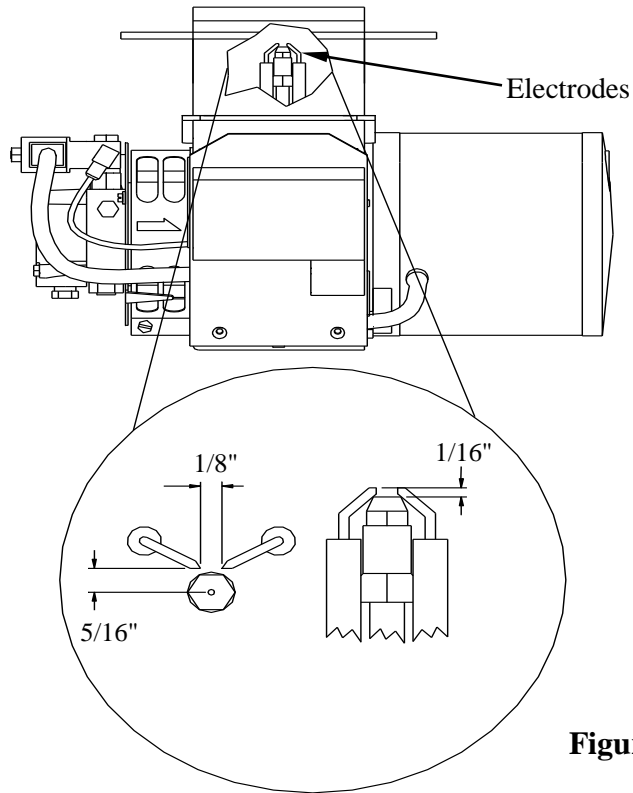

**Figure 22**

### NOTE TO COMMERCIAL USERS:

All mechanical equipment, no matter how well designed, will need maintenance and repairs. A Northstar pressure washer is no exception. At times, a Northstar pressure washer may become inoperable because repairs are required. Northstar Product Support will assist in these repairs as needed, but if an inoperable pressure washer creates a major expense to your business, then we strongly recommend the following:

- Have a staff person become familiar with the mechanical operation of the pressure washer and capable of making minor repairs and performing all preventative maintenance procedures.
- Keep a stock of recommended service parts for maintenance and minor repairs.

### **IMPORTANT:**

If a part needs replacement, only use parts that meet the manufacturer's part number specifications. Replacement parts that do not meet specifications may result in a safety hazard or poor operation of the pressure washer.

**Contact NorthStar Product Support at 1-800-270-0810 for any questions, problems, or parts orders.**

# Troubleshooting

Engine Will Not Start	
<i>Causes</i>	<i>Solutions</i>
Low Oil Shutdown	Fill engine with the adequate amount of oil.
Cold Engine	Choke engine to start.
No Fuel	Add gas to fuel tank, make sure fuel shutoff valve is open.
Dead Battery	Recharge/Replace battery.
Spark plug wire not attached	Attach spark plug wire to spark plug.

Pressure Washer Runs But Burner Doesn't Fire	
<i>Causes</i>	<i>Solutions</i>
Heat switch turned OFF	Turn heat switch ON.
Thermostat set too low or off	Set thermostat to desired temp.
Fuel tank empty	Fill fuel tank with kerosene, diesel, or fuel oil.
Defective Burner	Call Customer Service.

Pressure Washer Runs But No Pressure	
<i>Causes</i>	<i>Solutions</i>
Partially clogged or damaged nozzle	Clean or replace nozzle.
Low water flow	Make sure the water supply is more than 4.8 gpm.

Pressure Washer Surges Or Cycles While In Bypass	
<i>Causes</i>	<i>Solutions</i>
Leak between unloader and gun.	Check all connections between unloader and gun for leaks. Tighten loose components and replace damaged components.
Gun leaking internally	Replace spray gun.

Smoke From Heat Exchanger	
<i>Causes</i>	<i>Solutions</i>
Air band not adjusted properly	Adjust the air band until the burner burns cleanly. See <i>Installation Instructions</i>
Poor quality fuel	Use kerosene for the cleanest burn.

Water Not Heating Sufficiently	
<i>Causes</i>	<i>Solutions</i>
Scale build-up in coil	See <i>Coil Descaling</i> under <i>Maintenance Instructions</i> .
Coil is full of soot	See <i>Coil Desooting</i> under <i>Maintenance Instructions</i> .

Rupture Disc Sprays Water	
<i>Causes</i>	<i>Solutions</i>
Pressure Washer/Burner Problem	Call Customer Service

Poor Or No Detergent Supply	
<i>Causes</i>	<i>Solutions</i>
Soap control knob set too low.	Adjust soap control knob.
Inadequate detergent supply	Refill detergent container. Make sure chemical strainer is fully submerged.
High pressure hose too long	Use less hose. Move machine closer to the work.
Chemical strainer or injector clogged	Clean the strainer and injector. Always start with a clean detergent container. Run clean water through the injector after each use.

**Any Questions, Comments, Problems, or Parts Orders**  
***Call NorthStar Product Support 1-800-270-0810***

# Parts Explosion M157310 – Rev AD.2

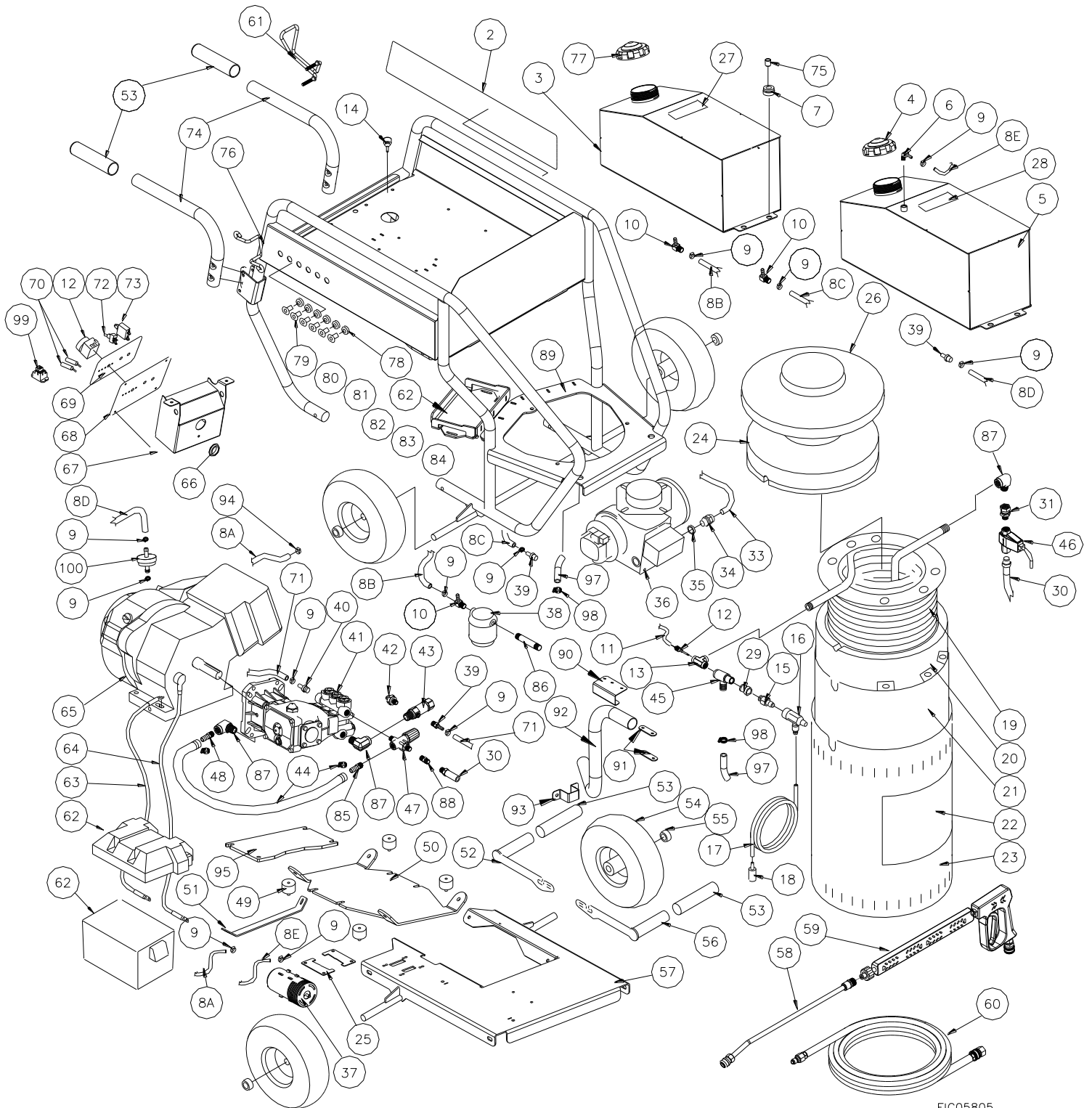

FIG05805

## Parts Explosion M157310 – Rev AD.2

Ref#	Part #	Description	Qty
1	793846	Outer Frame	1
2	789546	Decal, Instructions	1
3	791574	Fuel Tank (Yellow)	1
4	784769	Sealed Fuel Cap	1
5	791575	Gas Tank (Red)	1
6	786836	Tank Vent Fitting	1
7	787991	Rubber Grommets	8
8A	785337	4.5mm Fuel Line Hose	31"
8B	777345	1/4" Fuel Line Hose	28"
8C	777345	1/4" Fuel Line Hose	32"
8D	777345	1/4" Fuel Line Hose	18"
8E	777345	1/4" Fuel Line Hose	53"
9	777834	1/4" Hose Clamp	12
10	783212	1/4" MPT X 1/4" HB Elbow	3
11	30501	1/4" Split Loom	58"
12	790561	Thermostat	1
13	305208	1/2" Tee, Plated Steel	1
14	787259	1/2" Rubber Bumper	12
15	777913	Quick Couple Nipple, 3/8" male	1
16	779614	Chemical Injector, QC	1
17	777165	1/4" Braided Chemical Hose	48"
18	221222	Chemical Strainer	1
19	779228	Heating Coil	1
20	33387	Ceramic Insulation Can	1
21	779232	Inner Wrap	1
22	789000	Decal, NorthStar	1
23	780397	Stainless Steel Wrap	1
24	38398	Ceramic Insulation Lid	1
25	787686GB	Carb Canister Hold Down Plate	2
26	35331	Lid, Heat Exchanger	1
27	787827	Diesel Only Decal	1
28	777666	Gas Only Decal	1
29	30048	Reducer 8MP-6FP	1
30	37549	3/8 36" 3000PSI RXS Assembly	1
31	38379	Swivel fitting 6MP-8FPS	1
33	787131	Wire Harness	1
34	22502	Strain Relief	1
35	305267	Strain Relief Nut, 1/2" NPT	1
36	792322	ADC Burner, 12V	1
37	783016	Carbon Canister	1
38	32308	Fuel Filter/Water Separator	1
39	777340	1/4" Hose Barb X 1/4" MPT	3
40	38584	3/8" NPT Easy Start Valve	1
41	38198	66DX40GG1 Cat Pump	1
42	35918	Thermal Protector	1
43	35169	Inlet Filter	1
44	2264	1/2" Low Pressure Hose	15"
	777119	1/2" Hose Clamp	2
45	794071	Rupture Disc Kit, 8500 PSI	1
46	791691	Flow Switch	1
47	788420	Unloader	1
48	2294	1/2" NPT x 1/2" Hose Barb	1
49	30825	1.0" Iso Mount CR50	4

Ref#	Part #	Description	Qty
50	778219	ISO-Mount Plate	1
51	778228	ISO Support Bar	1
52	777232	Rear Brake	1
53	30747	Handle/Brake Grip	4
54	778295	Turf Tire	4
55	305200	Wheel Retainer	4
56	777231	Front Brake	1
57	790074	Base	1
58	791278	18.5" Lance Extension	1
59	779165	Gun With Lance	1
60	38525	50' Quick Couple Hose	1
61	788596	Hose Hook	1
62	777352	Battery Box	1
63	787445	Battery Cable, Red W/ Lug Terminal	1
64	787446	Battery Cable Black W/ Lug Terminal	1
65	788038	13 HP Honda GX390	1
66	31985	Grommet	1
67	787515	Control Box	1
68	778207	Control Box Front	1
69	777660	Decal, Control Panel	1
70	777646	Red LED, 12 VDC	2
71	777165	1/4" Braided Chemical Hose (Bypass)	24"
72	777855	Toggle Switch	1
73	31085	Circuit Breaker	1
74	790073	Handles	2
75	787992	Steel Bushings	8
76	789547	Decal, Nozzles	1
77	305206	Printed Fuel Cap	1
78	35198	Grommet	6
79	778945	Nozzle, 15° QC, #3.5 (Steam)–Yellow	1
80	778949	Nozzle, Soap QC, #4.5 – Black	1
81	782122	Nozzle, 0° QC, #4.5 –Red	1
82	782120	Nozzle, 15° QC, #4.5 – Yellow	1
83	777844	Nozzle, 25° QC, #4.5 – Green	1
84	778737	Nozzle, 40° QC, #4.5 – White	1
85	777839	1/2" HB x 3/8 MPT	1
86	305239	1/4" NPT X 3" Steel Pipe Nipple	1
87	5027	8 MP – 8 FP 90 Elbow	3
88	786891	Coupler, 3/8 NPT	1
89	778111	Heat Exchanger Mount	1
90	785936	Bracket, thermostat guard	1
91	785928	Tie plate, thermostat guard	2
92	788460	Metal tube, thermostat guard	1
93	787706	Tie strap, thermostat guard	1
94	786123	3/8" Spring Action Hose Clamp	1
95	778988	Engine Spacer Plate	1
97	30289	Hose, 3/4"	1
98	17141	3/4" Hose Clamp	2
99	791375	12 Volt Relay	1
100	30755	Fuel filter	1

# Pump Explosion – Rev AD.2

## EXPLODED VIEW

April 2005

## 66DX PLUNGER PUMP

With Unloader/Injector

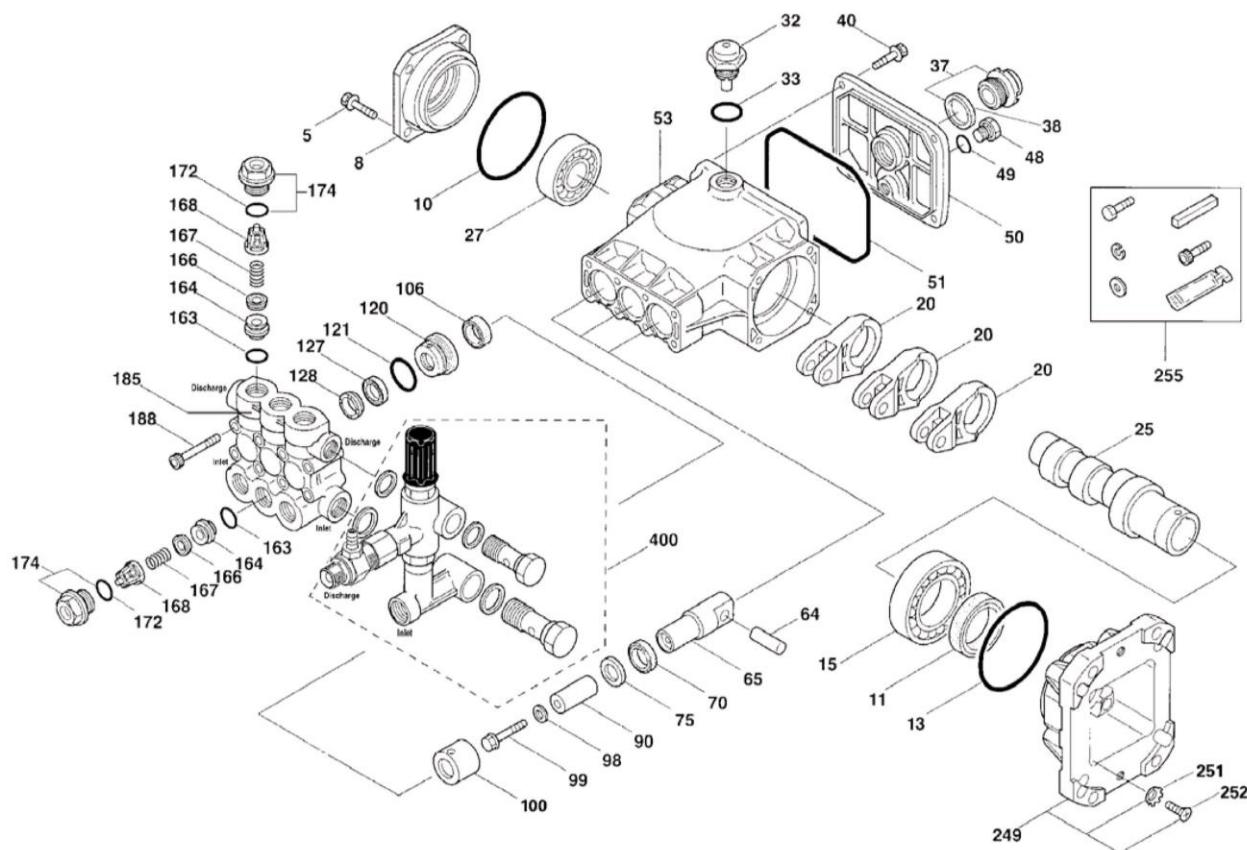

## PARTS LIST

ITEM	P/N	MATL	DESCRIPTION	QTY	ITEM	P/N	MATL	DESCRIPTION	QTY
5	92519	STZP	Screw, Sems HHC (M6x16)	4	100	48755	NY	Retainer, Seal	3
8	48259	AL	Cover, Bearing	1	106	45188	NBR	Seal, LPS w/S-Spg	3
10	14028	NBR	O-Ring, Bearing Cover - 70D	1	120	48759	BB	Case, Seal	3
11	46419	NBR	Seal, Oil, Crankshaft - 70D	1	121	13980	NBR	O-Ring, Seal Case - 70D	3
13	14037	NBR	O-Ring, Bearing Cover - 70D	1	127	48758	SNG	V-Packing	3
15	146421	STL	Bearing, Ball - Inner	1	128	48757	NY	Adapter, Male	3
20	48843	TNM	Rod, Connecting	3	163	17547	NBR	O-Ring, Seat - 85D	6
25	48970	CM	Crankshaft (8.6 mm) 30G11	1	164	45790	S	Seat	6
	48977	CM	Crankshaft (10.0 mm) 35G11	1	166	46429	S	Valve	6
	48839	CM	Crankshaft (11.4 mm) 40G11	1	167	43750	S	Spring	6
27	14480	STL	Bearing, Ball - Outer	1	168	46583	NY	Retainer, Spring	6
32	46798	—	Cap, Domed, Oil Filler	1	172	17616	NBR	O-Ring, Valve Plug - 70D	6
33	14179	NBR	O-Ring, Filler Cap - 70D	1	174	48760	BB	Plug, Valve w/O-Ring	6
37	92241	—	Gauge, Oil Bubble w/Gasket	1	185	48846	BB	Head, Manifold	1
38	44428	NBR	Gasket, Flat, Oil Gauge - 80D	1	188	87870	STZP	Screw, HSH (M8x65)	8
40	92519	STZP	Screw, Sems HHC (M6x16)	4	249	48841	AL	Flange Mount	1
48	25625	STCP	Plug, Drain (1/4"x19BSP)	1	251	46123	STZP	Lockwasher, Conical (M8)	4
49	23170	NBR	O-Ring, Drain Plug - 70D	1	252	46403	STZP	Screw, FH (M8x25)	4
50	48862	AL	Cover, Rear	1	255	30510	STZP	Assy, Bolt Mount	1
51	14048	NBR	O-Ring, Rear Cover - 70D	1		34100	STZP	Screw (3/8-16x1-3/8")	4
53	48830	AL	Crankcase	1		30921	STZP	Lockwasher (3/8")	4
64	46404	CM	Pin, Crosshead	3		30980	STZP	Washer, Flat (3/8")	4
65	48845	BB	Rod, Plunger	3		6106	—	Antiseize Lubricant	1
70	48911	NBR	Seal, Oil, Crankcase	3		45217	STL	Key (1/4"x1/4"x2-1/2") HD	1
75	48754	NBR	Slinger, Barrier - 70D	3		87788	STZP	Screw, Set (M5x8)	1
90	48752	CC	Plunger (M14x47)	3	300	34262	NBR	Kit, Seal (Incls: 98,106,121,127,128)	1
98	46730	NBR	Washer Seal, Plunger Retainer - 90D	3	310	34260	NBR	Kit, Valve (Incls: 163,164,166,167,168,172)	2
99	48201	SSL	Retainer, Plunger	3	400	7800	BB	Unloader Assembly w/Fixed Injector	1

*Italics are optional items. See Tech Bulletins 024, 060, 074 and 083 for additional information.*

MATERIAL CODES (Not Part of Part Number): AL=Aluminum BB=Brass CC=Ceramic CM=Chrome-moly NBR=Medium Nitrile (Buna-N) NY=Nylon S=304SS SNG=Special Blend (Buna) SSL=316SS/Low Carbon STCP=Steel/Chrome Plated STL=Steel STZP=Steel/Zinc Plated TNM=Special High Strength



# Summary of Important Safety Information

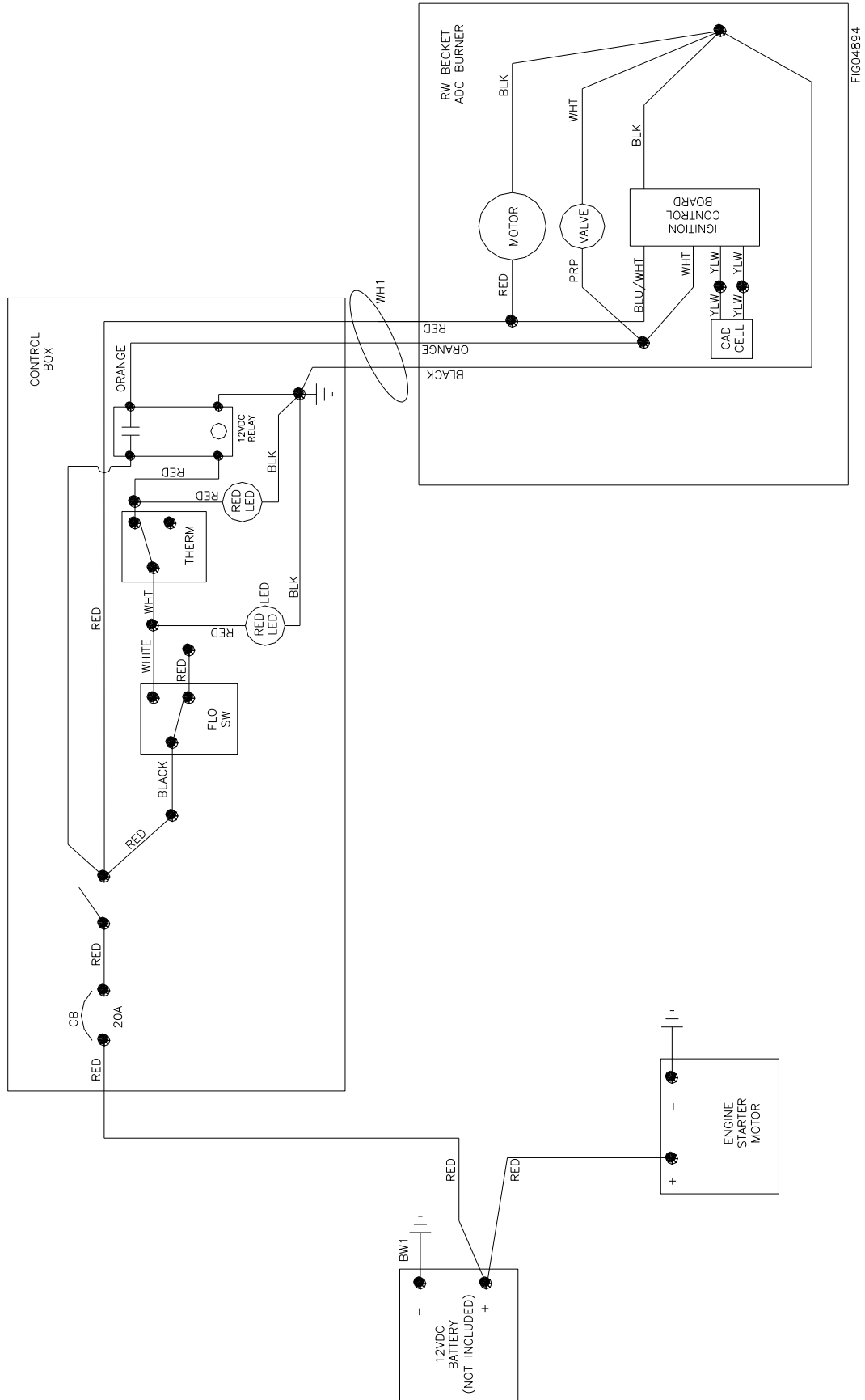

## Summary of Important Safety Information

This section provides a summary of the various safety procedures and measures that have been presented throughout the manual. Keep this summary handy and refer to it to refresh your memory about how to safely use your pressure washer.

### **WARNING**

**Carefully read and follow all instructions and safety information** for using this pressure washer. Improper use or maintenance of the pressure washer can result in *serious injury or death* to the operator or bystanders from:

- *Carbon monoxide poisoning*
- *Fire/explosion*
- *Chemical exposure*
- *Skin/eye injury from high pressure spray*
- *Burns*
- *Slips/falls*
- *Electric shock*
- *Flying objects/debris*

### **General**

- **Read all instructions.** Read and understand this Owner's Manual and the engine Owner's Manual completely before attempting to set-up and use the pressure washer. Serious injury or death can result if safety and other instructions are not followed.
- **Instruct all operators.** The pressure washer's owner must instruct all operators and potential renters in safe pressure washer set-up and operation. Do not allow anyone to operate the pressure washer who has not read the Owner's Manual and been instructed on its safe use. Owner's Manuals are available from North Star at 1-800-270-0810.
- **Adult control only.** Only trained adults should set up and operate the pressure washer. Do not let children operate. Pressure washers can generate forces greater than children can control and require judgment beyond what can be expected of children.
- **Under the influence.** Never operate, or let anyone else operate, the pressure washer while fatigued or under the influence of alcohol, drugs, or medication.
- **Understand intended use.** Carefully read about and understand the intended use of this pressure washer. Do not use for other purposes, as unforeseen hazards or equipment damage may result.

### **Prohibition Against Modifications**

Never modify or alter the pressure washer in any way, or deactivate any safety device. Modifications can create serious safety hazards and will also void the warranty.

- **Fuel/exhaust system.** Never add to or modify the exhaust system, fuel tank, or fuel lines. Carbon monoxide poisoning, fuel leaks, fire or explosion could result.
- **Unloader valve.** Do not attempt to alter the unloader valve's maximum pressure. Excess pressure could cause serious injury from escaping high-pressure fluids and/or pump damage. Any alteration other than turning the adjustment knob will void your warranty.
- **Guards.** Do not operate pressure washer unless all guards and cover shields are in place.

### **Safety – Installation & Set-up**

#### **Battery Safety**

Batteries are hazardous because they contain caustic acid, can emit explosive gases, and can cause electric shock. *Caution must be exercised when making connections to a battery to avoid shock and contact with the acid, and to prevent any sparking that could lead to an explosion.* Follow these and other safety rules carefully when connecting battery to pressure washer:

- **Eye/skin protection.** Always wear eye protection and protective clothing when connecting or disconnecting battery.
- **Sparks/Smoking.** Never smoke or work near sparks or other sources of ignition.
- **Electric shock.** Never touch both battery terminals at the same time with your hand or any non-insulated tools.
- **Connection/disconnection sequence.** ALWAYS connect and disconnect cables to the correct battery terminals in the proper sequence:
  - When CONNECTING the battery, connect the RED cable to the POSITIVE terminal FIRST.
  - When DISCONNECTING the battery, disconnect the BLACK cable from the NEGATIVE terminal FIRST
- **Acid/skin contact.** If battery acid contacts skin or clothing, flush immediately with water and neutralize with baking soda.

#### **Installation / Initial Set-up**

- **Level, heat-resistant surface.** Situate pressure washer on a firm, level, and heat-resistant surface with good drainage. Ensure it sits level and will not slide or shift during operation. Block wheels to prevent movement.

## Summary of Important Safety Information

- **Prevent carbon monoxide poisoning – Use outside only!** Exhaust fumes from both the engine and the burner contain carbon monoxide (CO), a poisonous gas you cannot see, smell, or taste. The CO generated by the pressure washer can rapidly accumulate, even in areas that appear to be well ventilated, resulting in dangerous and fatal concentrations within minutes. To prevent dangerous CO build-up:
  - ONLY use pressure washer outdoors and at least 20 feet from the home, away from windows, vents and air intakes, to allow proper ventilation. If you start to feel sick, dizzy, or weak while using the pressure washer, shut off the engine and get to fresh air RIGHT AWAY.
  - NEVER run pressure washer in an enclosed or partially enclosed location such as a building, garage, shed, or vehicle. Running a fan or opening windows will not provide adequate ventilation to prevent dangerous CO build-up.
- **Adequate ventilation.** The pressure washer needs adequate, unobstructed flow of air to allow for proper combustion and cooling. Situate so there is adequate clearance around pressure washer to allow for airflow – at least 7' from any non-combustible wall or obstruction. Never place any objects against or on top of pressure washer.
- **CO alarms.** Ensure that working, battery-operated or battery back-up carbon monoxide alarms are used in any dwelling/structure that is in close proximity to the running pressure washer.
- **Hot exhaust - fires.** Exhausts from engine and burner can be extremely hot and cause fire. Position sprayer so engine and burner exhausts are at least 7' away from combustible objects during operation.
- **Spark arrestor usage.** Equip engine with a spark arrestor if pressure washer will be used near any ignitable forest, brush, or grassy land. See the "Specifications" section of this manual to determine if your pressure washer is already equipped. In such conditions, make sure you comply with applicable local, state and federal codes.

### Fuel Safety

Gasoline is highly flammable and explosive; and burner fuels are combustible at warm temperatures. You can be burned or seriously injured when handling fuel. Using extreme care when handling fuel, including these preventative measures:

- **Fuel outdoors.** Fill fuel tank outdoors – never indoors. Fuel vapors can ignite if they collect inside an enclosure. Explosion can result.
- **Use approved container.** Never pump fuel directly into fuel tank at gas station. Static charge can build and ignite fuel. Use an UL approved fuel container to transfer fuel to the engine.
- **Running / hot engine.** A hot engine or burner is hot enough to ignite fuel. Never add fuel or remove fuel cap if engine or burner are running or still hot. Allow engine to cool at least two minutes before adding fuel.
- **Heat / flames / sparks.** Stay away from sources of heat, flame, or sparks while adding fuel.
- **Don't overfill.** DO NOT overfill the fuel tank. Allow at least 1/2" of empty space below the fill neck to allow for fuel expansion.
- **Replace cap.** Replace fuel cap securely before starting engine.
- **Spills.** Clean up fuel spills immediately. Move pressure washer away from spilled fuel on the ground. Wipe fuel off engine and wait 5 minutes for excess fuel to evaporate before starting engine. Fuel soaked rags should be disposed of properly.
- **On skin / clothes.** If fuel is spilled on your skin or clothes, change clothes and wash skin immediately.
- **Inspect fuel system.** Check fuel tanks and fuel system on a regular basis. Look for signs of leaks, deterioration, chafed or spongy fuel hose, loose or missing fuel hose clamps, damaged fuel tank, or a defective fuel shut-off valve. Do not start pressure washer until needed repairs have been completed.
- **Fuel storage.** Store fuel in a cool, dry place in an UL-approved, tightly sealed container.

## Safety – Operation

### Pre-start

- **Review safety rules.** Before each use of this pressure washer, review the "Rules for Safe Operation." Failure to follow these rules may result in serious injury or death.
- **Know how to stop.** Be thoroughly familiar with proper use of the equipment and all controls and connections. Know how to stop the pressure washer and relieve system pressure quickly if needed.
- **Danger: High-pressure fluid injection hazard.** High-pressure fluid spray or discharge from leaks (even pin-sized) or ruptured components can pierce the skin and inject fluid into the body. Injection injury can result in blood poisoning and/or severe tissue damage leading to infection, gangrene and possibly amputation.
- **Check/maintain machine before each use.** Check hoses & fittings for damage and leaks before use. Ensure all components are properly connected. Follow all maintenance instructions specified in pressure washer and engine manuals.
  - Never operate machine with damaged or missing hoses/parts. Never attempt to repair a high-pressure hose or component. Always replace it with a part that is rated at or above the pressure rating of this machine.

## Summary of Important Safety Information

- Never run the machine without sufficient lubrication or sufficient water to cool the pump.
- Never operate unless all safety guards are in place.
- **Position safely.** Place sprayer on firm, level ground to prevent accidental falls and equipment tip-over.
- **Not in presence of combustibles.** Do not use the pressure washer in the presence of flammable vapors, dust, gases, or other potentially combustible materials. Operate only where open flame or torch is permitted
- **Use backflow preventer.** The use of a back flow preventer (Part #222815 call 1-800-270-0810 to order) on the water supply hose is recommended and may be required by local code.
- **Clear work area.** Clear work area of all bystanders. Keep children and pets away.
- **Wear protective gear.** High-pressure spray can cause eye/skin injury, hot water can burn, and flying objects/debris can cause injury. Serious injection injury can result if high-pressure spray penetrates the skin. Operators should wear waterproof, thermally insulated gloves, safety glasses with side and top protection, face protection, and protective clothing when operating the machine. If spraying pressure washer specific cleaning chemicals, wear a respirator or mask to avoid inhalation of vapors if directed on the chemical label.
- **Wear non-slip footwear.** Use of pressure washer can create puddles and slippery surfaces. Wear footwear capable of maintaining a good grip on wet surfaces.
- **Check sprayer nozzle.** Sprayer nozzle can become a projectile and cause serious personal injury or property damage if not properly connected to the spray gun. Check to ensure the nozzle has been properly attached to the spray gun before using the pressure washer.

### During use

- **Safety latch locked before starting engine.** Always engage the safety latch on the spray gun trigger before starting the engine.
- **Incoming water supply on.** Do not run the pump without the water supply connected and turned on. Operating the pressure washer without an incoming flow of water will damage the pump.
- **Wait before re-lighting burner.** NEVER attempt to immediately run or re-light the burner if it doesn't ignite the first time. Unburned oil or gas may have accumulated, causing potential explosion or fire hazard.
- **Use two hands.** Pressure washer spray gun kicks back when triggered. Firmly grasp with two hands.
- **Stay alert.** Watch what you are doing at all times.
- **Prevent slips / loss of balance.** High-pressure spray could cause you to lose balance from kickback forces, and wet surfaces can be slippery.
  - Keep good footing and balance at all times.
  - Do not overreach.
  - Do not stand on unstable support when spraying.
  - Use extreme caution when spraying from a ladder or scaffolding, ensure it is firmly anchored from sway or tip-over. Use extreme caution to avoid falling as spray gun kick can propel you off the ladder or scaffolding.
  - Be aware of puddles and slippery surfaces. Ensure there is adequate drainage to prevent pooling of water.
- **Keep spray away from people.** Never direct discharge stream at or near any person. Do not allow any part of the body to come in contact with the fluid stream. High-pressure spray will cause serious skin, eye, or falling injuries, and hot water can burn. Injection injury will occur if high-pressure spray pierces the skin, injecting liquid under the skin. Injection injury can result in blood poisoning and/or severe tissue damage leading to infection, gangrene and possibly amputation.
- **Prevent surface damage & flying debris** – Surfaces being sprayed must be strong enough to withstand high-pressure spray, or damage may result. In addition, high-pressure spray will dislodge unsecured objects as well as surface chips and debris, resulting in hazardous flying objects that can cause personal injury or property damage. Do not spray brittle surfaces or breakable, fragile, or unsecured objects such as:
  - stucco or laminar flagstone
  - some painted surfaces
  - windows or glass doors (because they may break)
  - light fixtures, flowerbeds, mailboxes
  - unsecured, lightweight objects
- **Do not lock spray gun trigger in ON position.** To reduce risk of injury, do not attempt to secure the spray gun open by blocking or tying the spray gun in the open position.
- **Keep spray away from electrical wiring.** Spray contact with electrical wiring will likely result in severe electrical shock or electrocution.
- **Use only approved cleaning chemicals.** Only chemicals specifically designed for use in pressure washers may be used. Never spray acids, corrosives, or abrasive or flammable liquids. Breathing hazards, surface burns/corrosion, or fire/explosion could result.
- **Follow cleaning chemical manufacturer's instructions.** Follow the chemical manufacturer's label instructions when handling or spraying chemicals. Understand all safety hazards and first aid for all chemicals being used. Wear protective gear as directed.

## Summary of Important Safety Information

Always wear protective gloves when handling and cleaning with chemicals. When cleaning filters, check whether dangerous chemicals have been used with the filter and take any precautions that may have been recommended by the supplier of these chemicals. Always dispose of hazardous fluids per local, state, and national guidelines.

- **Do not exceed pressure and or temperature limits.** Do NOT operate this pump with components (such as hose, connections, and spray gun) rated for lower pressure and or temperature limits than the machine's maximum rated pressure and temperature, or component could rupture and cause serious personal injury from escaping high pressure fluids. Do not set the rupture disc above the rated pressure. **If the high-pressure safety device ever discharges water, turn the engine off and do not use the machine. The rupture disc will no longer function properly. See a dealer or call Product Support at 1-800-270-0810.**
- **Never pull by hose.** Do not move this machine by pulling on the hose. Hose or connections could fail and result in catastrophic high-pressure release of fluid as well as hose whipping.
- **Avoid sharp objects.** Keep hose away from sharp objects. Bursting hoses may cause injury.
- **No load bearing.** Do not use the pump to support other items of equipment that impose unacceptable loads on the pump. Do not attempt to use this machine as a prop.
- **Hot exhaust/parts.** Stay clear of engine and burner exhausts. Never touch hot engine muffler, burner/heating coil, or other hot surfaces. All are very hot and will burn you.
- **Hot spray gun metal when using burner.** Never touch the metal screw or any metal parts of the spray gun when the heater is being used – the metal gets very hot and will burn you.
- **Smoking/sparks.** Never smoke near the running engine, and never operate near sources of sparks or flames as flammable fuel vapors are in the vicinity of the pressure washer.
- **Lock trigger safety latch when not spraying.** Spray gun is equipped with a built-in trigger safety latch to guard against accidental trigger release. Rotate safety latch to the locked position when not spraying.
- **Relieve water pressure.** Always stop the product and relieve system pressure before leaving the sprayer unattended, or when disconnecting hoses, removing nozzles, or servicing the pump.
- **Refueling.** Never add gasoline to the engine or fuel to the burner unless unit is off and has cooled.
- **Do not direct spray at this machine.** Do not attempt to clean this machine with its own spray. Engine damage will result. Cleaning should be done with a damp sponge with the engine OFF.
- **Seek medical aid for suspected carbon monoxide poisoning.** The running engine gives off carbon monoxide, a poisonous gas that can kill you. If you start to feel sick, dizzy, or weak while using the pressure washer, shut off the engine and get to fresh air RIGHT AWAY. See a doctor. You may have carbon monoxide poisoning.
- **Seek medical aid for suspected injection injury.** If injured by high-pressure fluid, no matter how small the wound is, see a doctor at once. A typical injection injury may be a small puncture wound that does not look serious. However, severe infection or reaction can result if proper medical treatment is not administered immediately by a doctor who is familiar with injection injuries.
- **Other exhaust dangers.** This product contains or emits chemicals known to the State of California to cause cancer, birth defects or other reproductive harm. Avoid inhalation of exhaust.

### After use

- **Cool engine before storing.** Let engine cool for at least five minutes before storing. A hot engine is a fire hazard.
- **Prevent accidental starting.** When pressure washer is not in use, remove spark plug or spark plug wire in order to ensure that pressure washer cannot be started in a storage location or by untrained persons.
- **Storage location.** Store the pressure washer in a dry location away from sources of heat, open flames, sparks or pilot lights – such as water heaters, space heaters, furnaces, clothes dryers, or other gas appliances – EVEN IF the pressure washer's gas tank is empty, residual vapors or fuel could ignite.
- **Periodic maintenance.** Perform periodic maintenance as directed in this manual to keep the pressure washer in safe working condition.

## Safety - Inspection/Maintenance

Inspect and maintain your pressure washer on a regular basis and repair as needed to keep it in safe working condition:

- **Turn off / relieve pressure first.** Turn off pressure washer and relieve system pressure before inspection or maintenance. Remove spark plug or spark plug wire before working on the engine or pressure washer to prevent accidental starting.
- **Fuel valve off.** Turn fuel shut-off valve to OFF position before transporting or servicing the pressure washer.
- **Follow maintenance schedule.** Follow all maintenance instructions in this pressure washer manual and the engine manual.
- **Replace guards / shields.** Make sure all guards and shields are replaced after servicing the pressure washer.
- **Replacement parts.** If a part needs replacement, only use factory approved repair parts. Replacement parts that do not meet specifications may result in a safety hazard or poor operation of the pressure washer and will void the warranty.

# Limited Warranty

Dear Valued Customer:

The NorthStar Product you just purchased is built with the finest material and craftsmanship. Use this product properly and enjoy the benefits from its high performance. By purchasing a NorthStar product, you show a desire for quality and durability. Like all mechanical equipment this unit requires a due amount of care. Treat this unit like the high quality piece of machinery it is. Neglect and improper handling may impair its performance. Please thoroughly read the instructions and understand the operation before using your product. Always contact NorthStar Product Support at 1-800-270-0810 prior to having any service or warranty work performed, as some services performed by parties other than NorthStar approved service centers may void this warranty. This warranty is in lieu of any other warranty expressed or implied and NorthStar assumes no other responsibility or liability outside that expressed within this warranty.

## Limited Warranty

NorthStar shall warranty any piece of equipment manufactured, or parts of equipment manufactured, to be free from defects in material or workmanship for a period of:

NorthStar Warranty		
Item #	Consumer Warranty Period	Commercial Warranty Period
157310	2 years from date of purchase by user	2 years from date of purchase by user

Engine Warranty		
Item #	Consumer Warranty Period	Commercial Warranty Period
157310	3 years from date of purchase by user	3 years from date of purchase by user

“Consumer use” means personal residential household use by a consumer. “Commercial use” means all other uses, including use for commercial, income producing or rental purposes or when purchased by a business.

This warranty applies to the original purchaser of the equipment (verification of purchase, in the form of a receipt, is the responsibility of the buyer), is non-transferable, and covers parts and labor. Parts will be replaced or repaired at no charge, except when the equipment has failed due to lack of proper maintenance. If a part is no longer available, the part may be replaced with a similar part of equal function. Any misuse, abuse, alteration or improper installation or operations will void warranty. Determining whether a part is to be replaced or repaired is the sole decision of NorthStar. NorthStar will not provide for replacement of complete products due to defective parts. Any costs incurred due to replacement or repair of items outside of a NorthStar approved facility is the responsibility of the buyer and not covered under warranty. Transportation costs to and from service center is the responsibility of the customer.

In addition to the normal warranty, NorthStar shall warrant any normal wear item from defects in material or workmanship for a period of 90 days from the date of purchase by user. Normal wear items include, but are not limited to, nozzles, quick connect fittings, valves, high and low pressure water seals/packing, high and low pressure hoses, O-rings, unloader valves and filter elements.

This warranty specifically excludes the following; failure of parts due to damage caused by accident, fire, flood, windstorm, acts of God, applications not approved by NorthStar in writing, corrosion caused by chemicals, use of replacement parts which do not conform to manufacturer's specifications, damage related to the use of biodiesel fuel, damage to accessory parts such as starting batteries, damage related to rodent and/or insect infestation and damage caused by vandalism. Additional exclusions: loss of running time, inconvenience, loss of income, or loss of use, including any implied warranty of merchantability of fitness for a specific use. Also, Outdoor Power Equipment needs periodic parts and service to perform well, and this warranty does not cover instances when normal use has exhausted the life of a component or the engine.

This warranty does not cover any personal injury or damage to surrounding property caused by failure of any part. Repair or replacement of parts does not extend the warranty period.

Normal burner maintenance such as cleaning and adjusting electrodes, descaling the coil, desooting the coil, air adjustments, fuel system cleaning and obstruction due to build up is not covered by this NorthStar warranty.

The engine warranty is covered under the terms and conditions as outlined by the engine manufactures warranty contained herein and is the sole responsibility of the engine manufacture. Normal engine maintenance such as spark plugs, air filters, adjustments, fuel system cleaning and obstruction due to build up is not covered by this NorthStar warranty.

Please fill in the following information and have it on hand when you call in on a warranty claim.

Customer Number: \_\_\_\_\_

Date of Purchase: \_\_\_\_\_

NorthStar Serial Number: \_\_\_\_\_

Item Number: \_\_\_\_\_

*This page has intentionally been left blank.*



Manufactured by  
Northern Tool + Equipment Co., Inc.  
Burnsville, MN 55306  
[NorthernTool.com](http://NorthernTool.com)